



Miriam G. Clinton
Rhodes College
Department of Art & Art History
clintonm@rhodes.edu

The House of the Rhyta at Pseira

The Science of Perception in Recreating the Experience of
Ancient Space

August 6, 2017

Alliance to Advance Liberal Arts Colleges Workshop

Vision Science as an Idealized Model for the Liberal Arts

The questions of phenomenology

- Is it possible to recreate the experience of ancient space?
- Is it a worthwhile attempt to do so, when modern humans can never bring the same cultural habitus to the physical world as their ancient counterparts did?
- If it isn't possible ever to understand the past, why study it?

Phenomenology in theory

“[Phenomenology] connects a symmetrical archaeology to major trends in the discipline since the 1960s and to key components of archaeological practice - relational ontologies, mixtures of past and present, people and things, biology and culture, individual and society. Symmetrical archaeology is a culmination of effort in archaeology to undercut these modernist dualities and to **recognize the vitality of the present past.** Symmetry adds new force to the claim that **archaeologists have a unique perspective on human engagements with things, on social agency and constructions of contemporary identity. ...**

Phenomenology in theory

“... The radical separation of past (to be studied) and the contemporary location and viewpoint of archaeologists is one that regularly involves according primacy to the past. For the past, uncontroversially would seem, can have happened only the way it did, and what did happen cannot be changed by the will of some later archaeologist. **The objective reality of the past, immediately present in archaeological remains, faces off the contemporary archaeologist possessed by a subjective will to know. ...**

Shanks 2007, p. 590

Phenomenology in theory

"... A successful account of the past is not so much a measure of accordance between the way things were and our archaeological account, as it is a personal and social achievement (Latour 1987). Archaeologists, under this attitude and understanding, do not discover the past. Archaeologists work on what is left of the past (Shanks 1992). And this process, of course, is something that takes us far beyond the academic discipline and profession (Schnapp et al. 2004). An archaeological sensibility of attending to traces and remains is one that unites the discipline and profession with memory and many practices and cultures of collection (Schnapp 1993). **Archaeology is a process of mutual self-constitution, under this attitude. Working on the past makes us who we are."**

Phenomenology in fieldwork

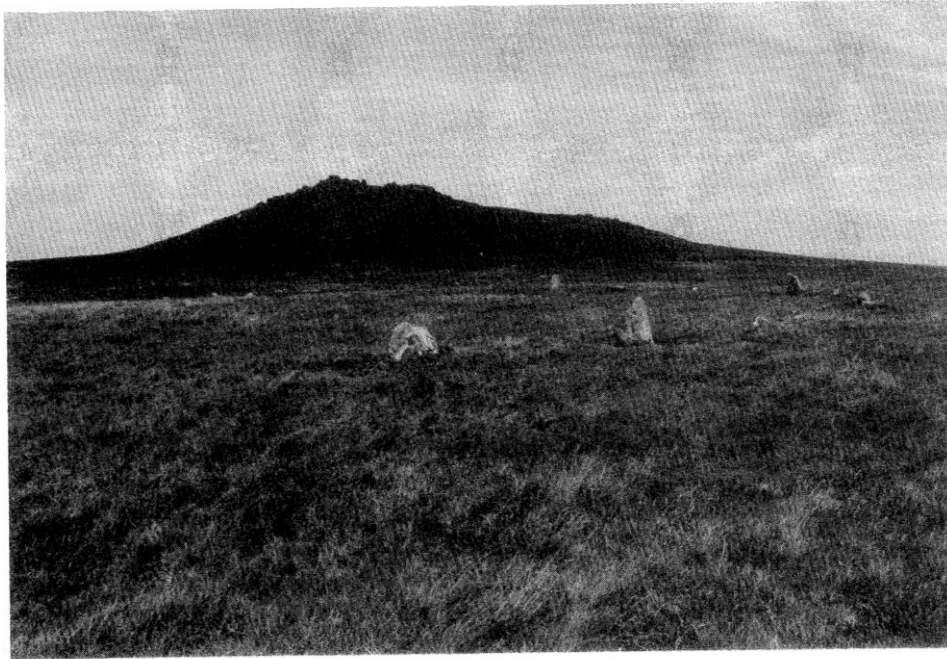

Plate 2 The Fernacre stone circle with the Rough Tor ridge beyond seen from the south.

Tilley 1996,
Pl. 2; Fig. 2

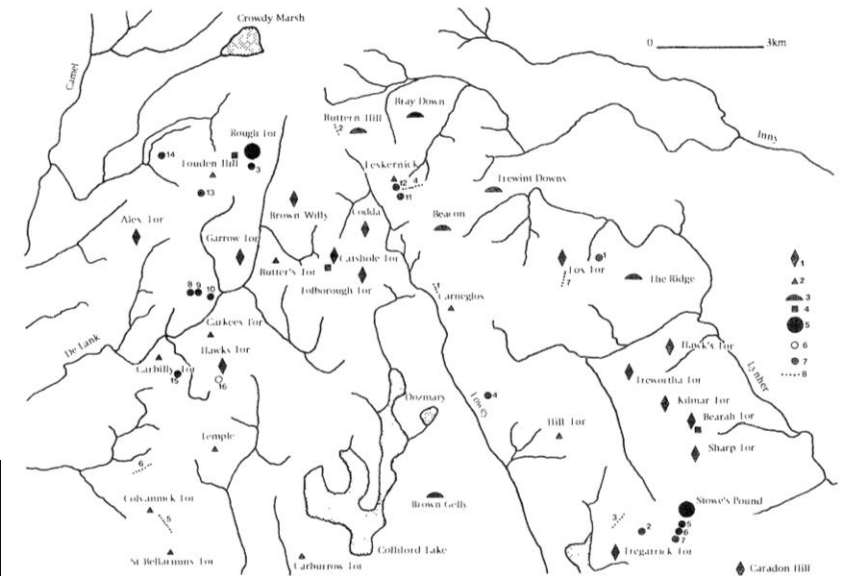

Figure 2 The distribution of earlier and later Neolithic monuments on Bodmin Moor in relation to Tors and hills: 1) Major Tor or rocky outcrop; 2) Minor Tor; 3) significant hills or ridges without visually significant rock outcrops; 4) long cairn; 5) ceremonial hill top enclosure; 6) henge with stone circle; 7) stone circle; 8) stone row.

Stone circles 1) Nine Stones, Altarnun; 2) Craddock Moor; 3) Fernacre; 4) Goodaver; 5-7) The Hurlers; 8-9) King Arthur's Downs; 10) Leaze; 11-12) Leskernick; 13) Loudon Hill; 14) Stannon; 15) Trippet Stones; 16) Stripple Stones (Circle Henge)

Stone rows 1) Carneglos; 2) Buttern Hill; 3) Craddock Moor; 4) Leskernick; 5) Cardinham Moor; 6) Trehudreth Downs

3D reconstruction of the House of the Rhyta, Pseira

3D Model
by M.G.
Clinton
and A.
MacLaughlin

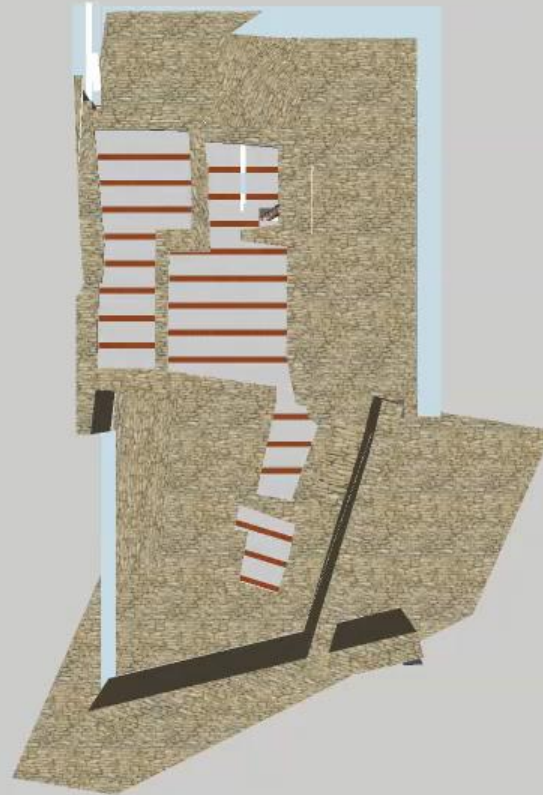

Pseira



Minoan Pseira

Betancourt 2009, Ill. 1.2

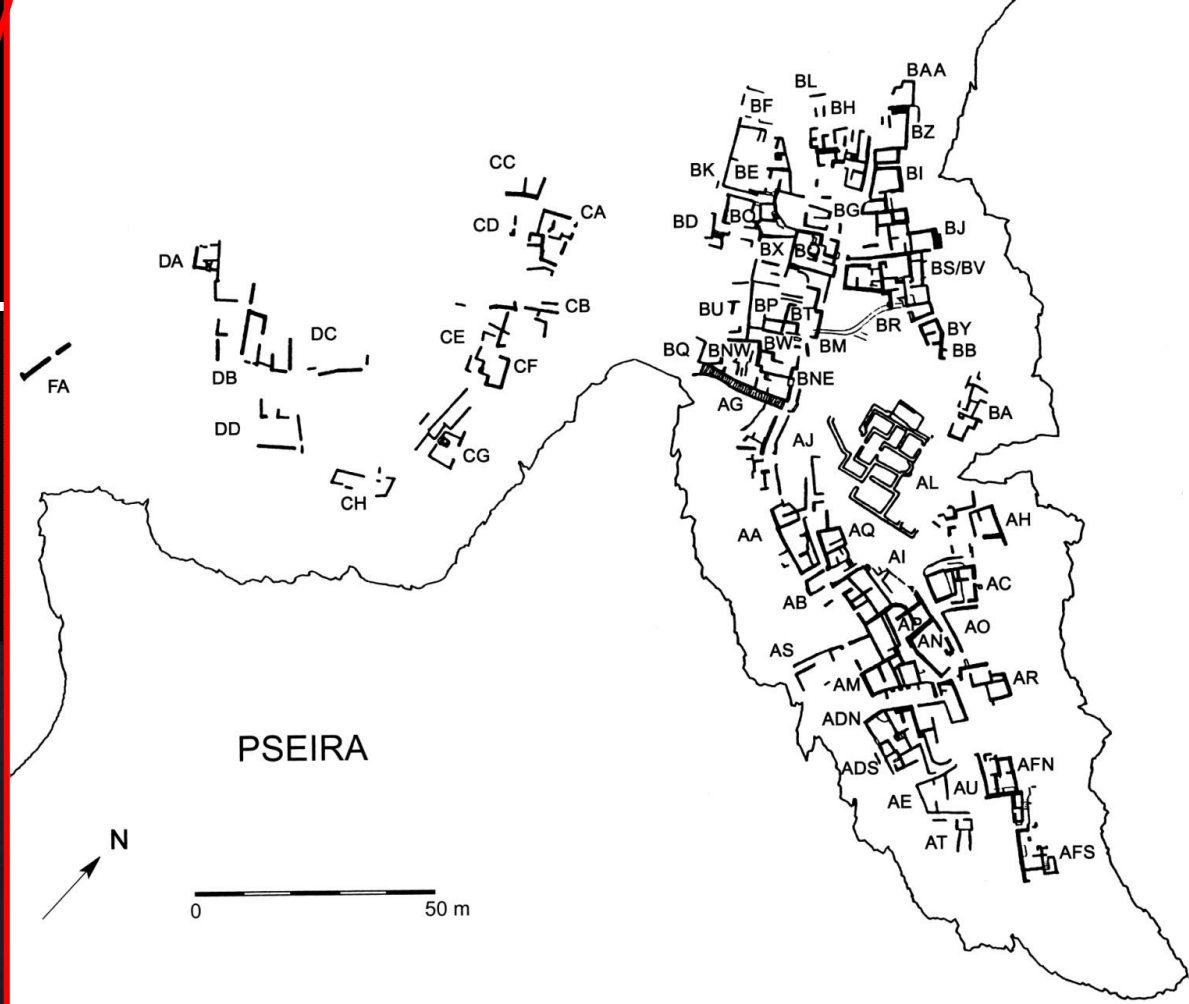

Google earth

Image © 2016 TerraMetrics
Data SIO, NOAA, U.S. Navy, NGA, GEBCO

Imagery Date: 7/21/2015 35°11'22.93" N 25°51'34.45" E elev. 138 m eye alt. 3.69 km

Block AF, Pseira

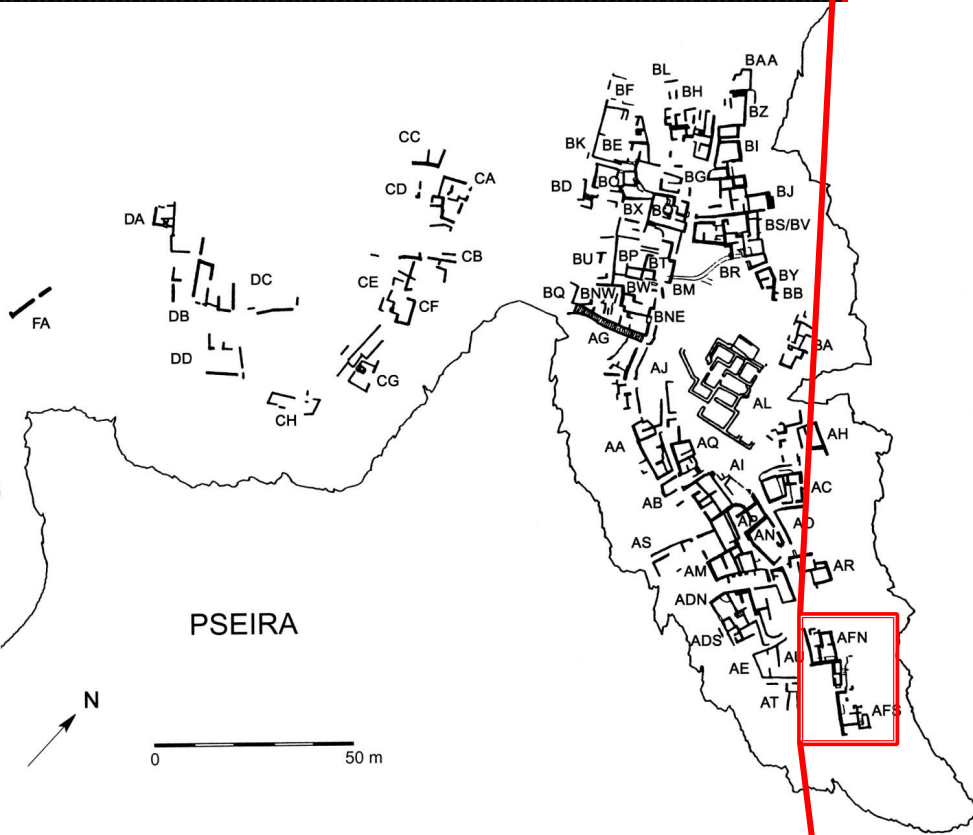

Betancourt 2009, Ill. 1.2

After
Betancourt 2009,
III. 2.1; 2.5

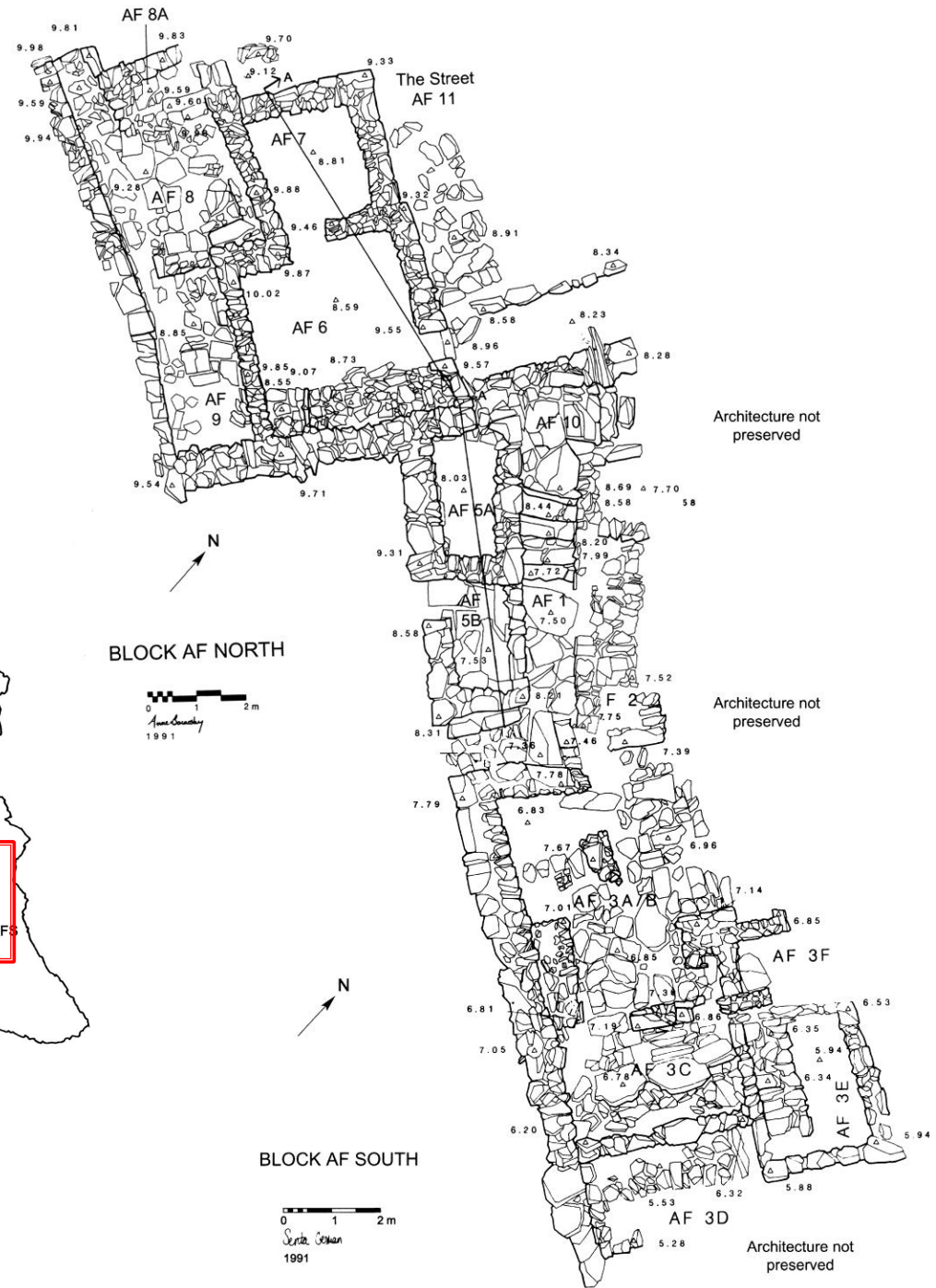

Betancourt 2009, Ill. 2.1

After
Betancourt
2009,
Ill. 2.1; 2.5

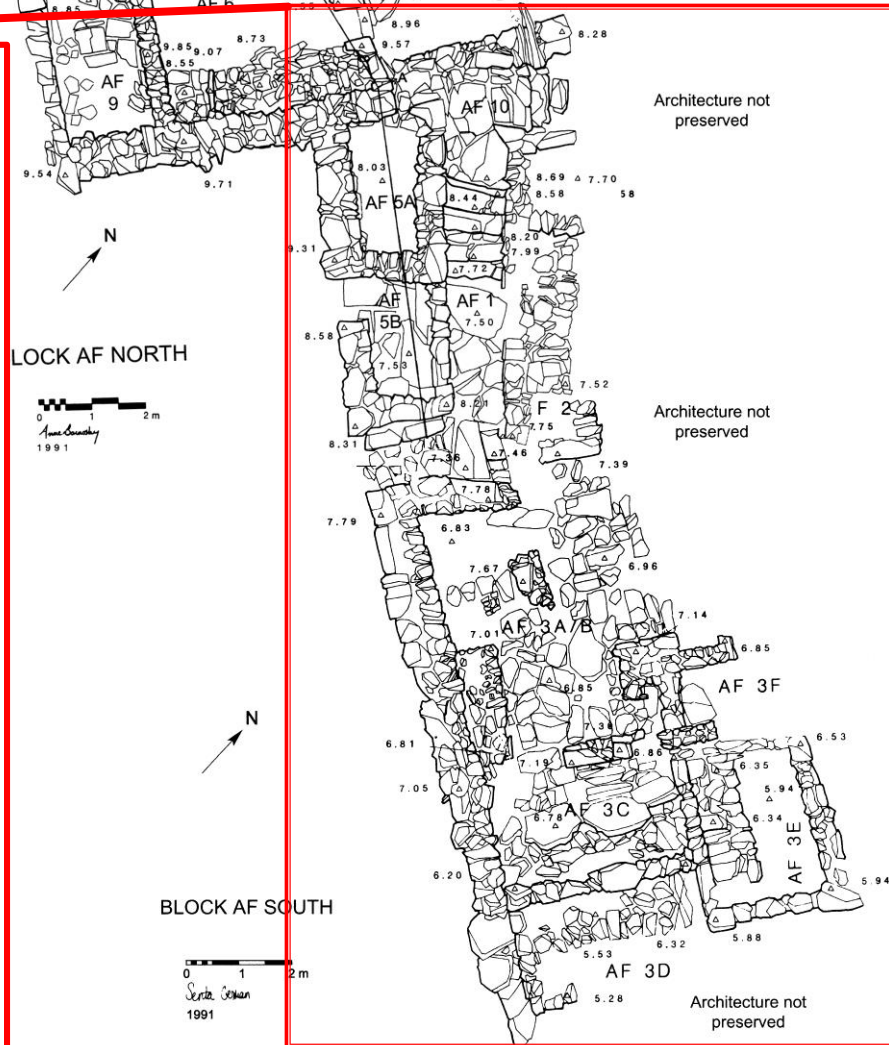
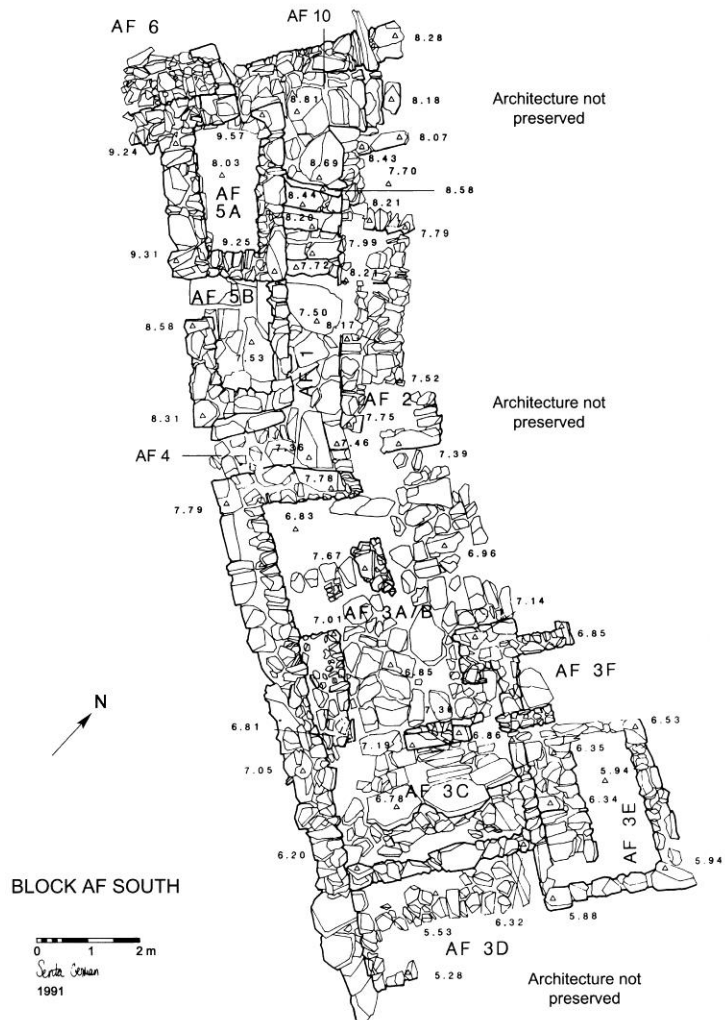

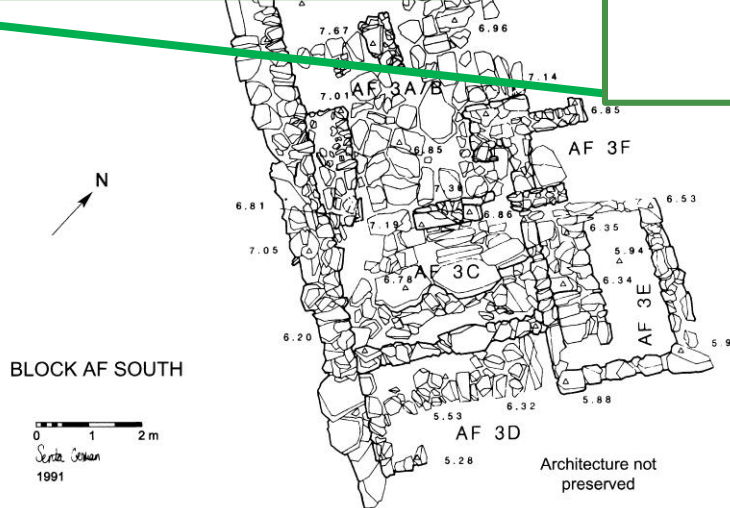
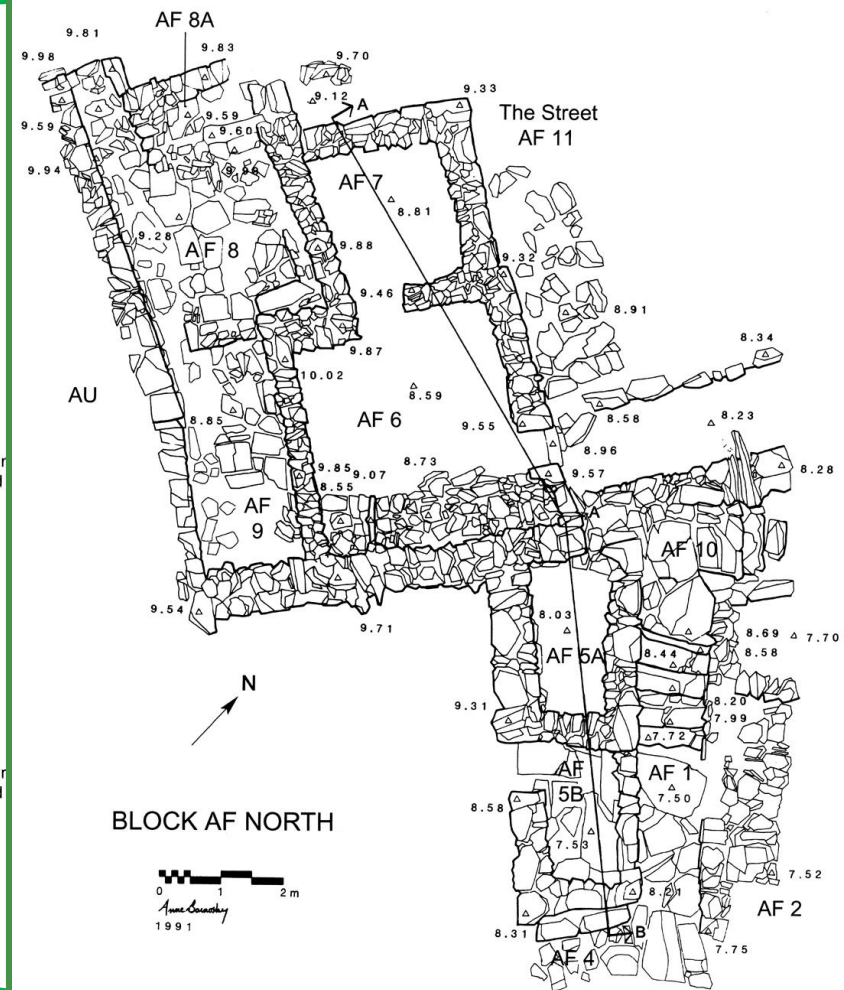
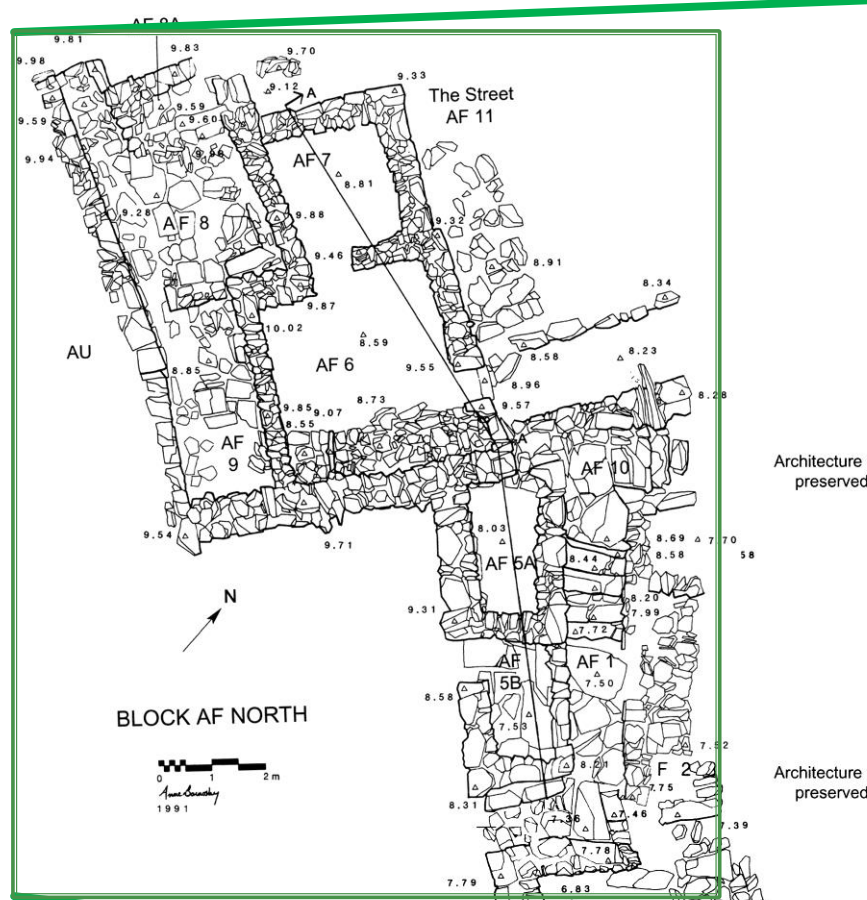

Betancourt 2009, Ill. 2.5

After
Betancourt 2009,
Ill. 2.1; 2.5

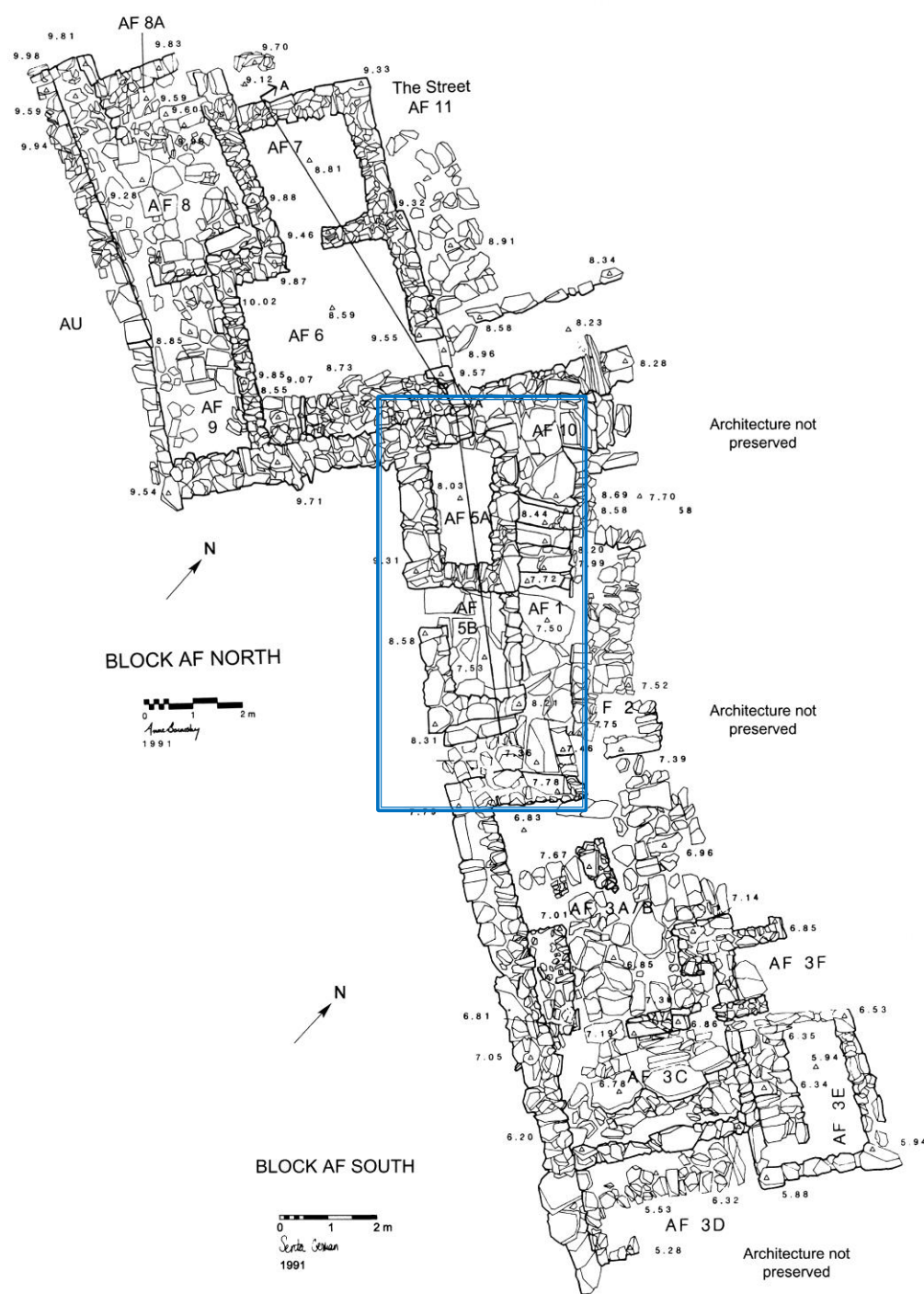

After
Betancourt
2009,
Ill. 2.1; 2.5

House of the Rhyta, Pseira

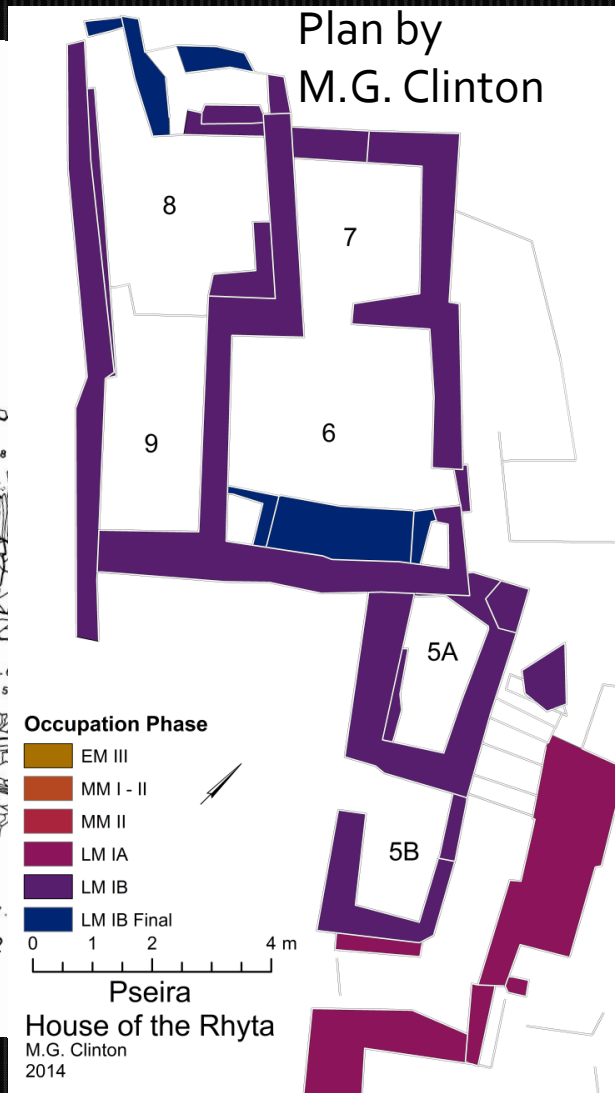
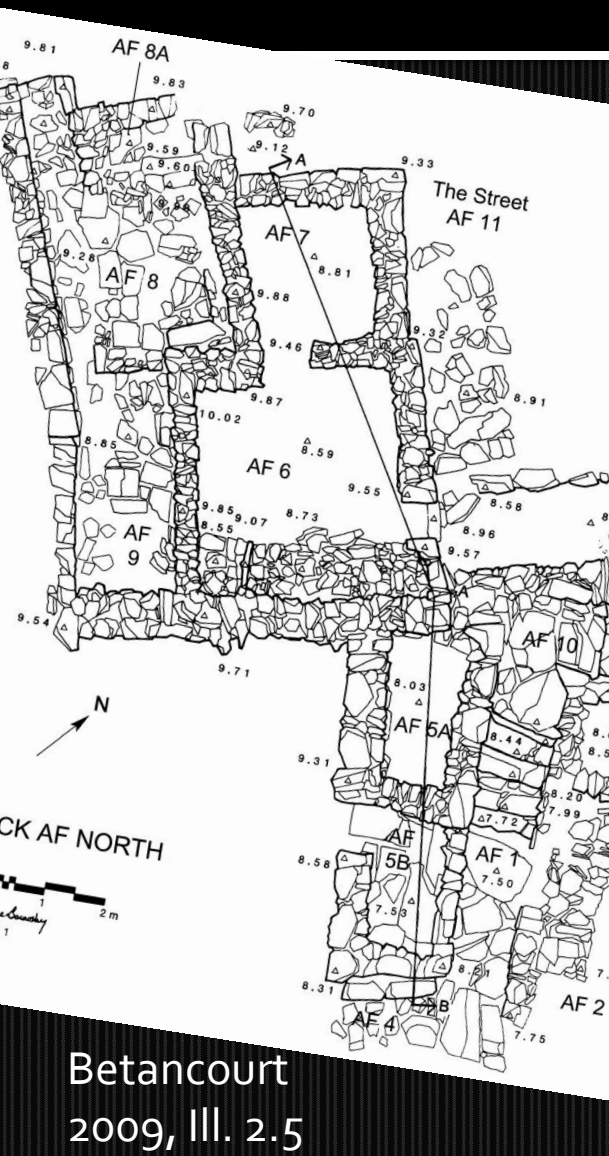

House of the Rhyta, Upper Terrace

Plan by
M.G.
Clinton

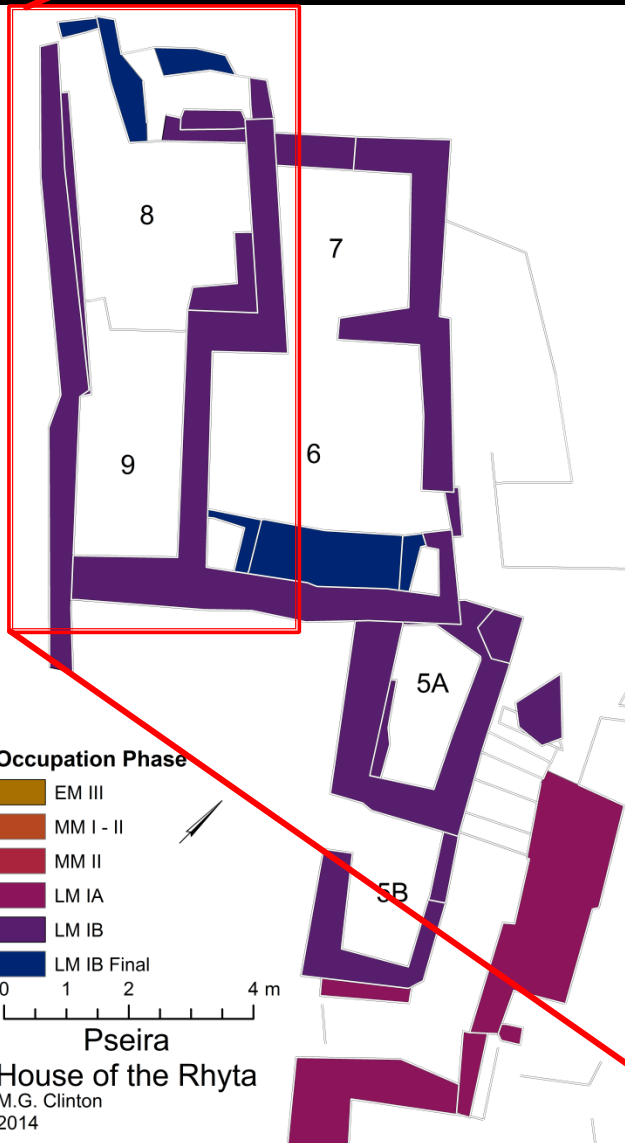

3D Model
by M.G.
Clinton

House of the Rhyta, Lower Terrace

Plan by
M.G.
Clinton

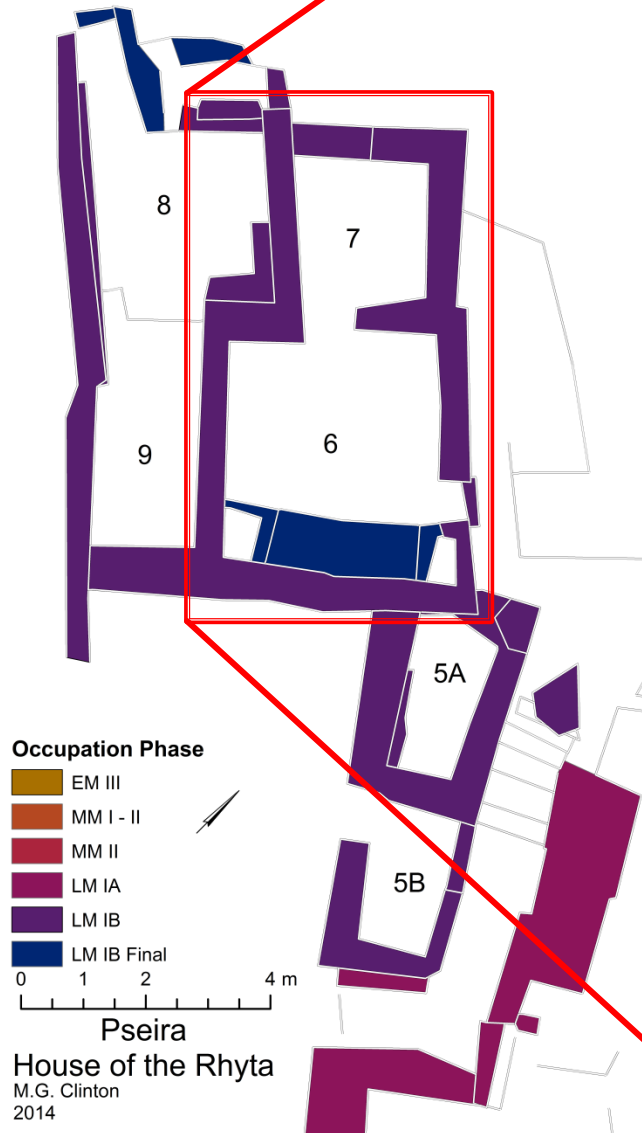

3D
Model
by
M.G.
Clinton



House of the Rhyta, Southern Rooms

Plan by
M.G.
Clinton

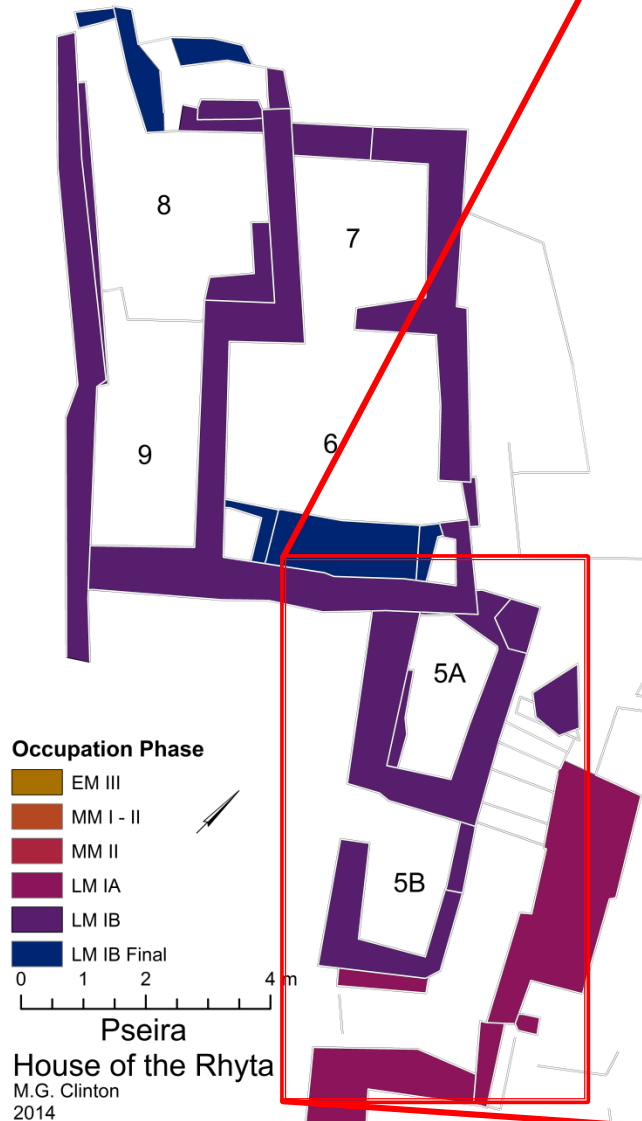

House of the Rhyta, upper story

Plan by
M.G.
Clinton

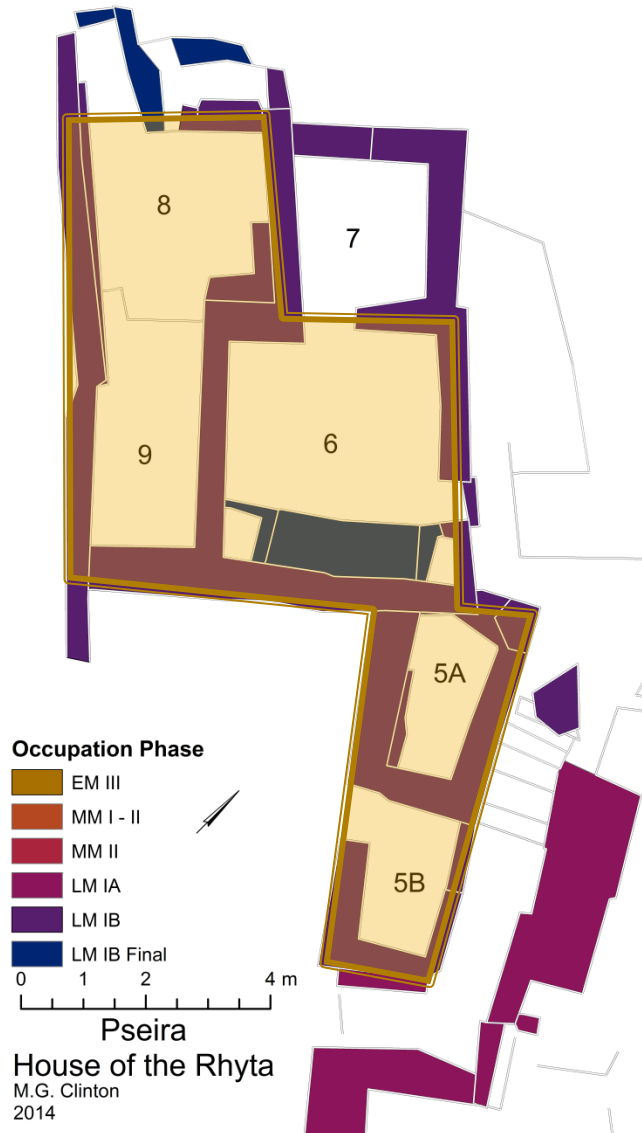

3D Model
by M.G.
Clinton

House of the Rhyta, upper story finds

Clinton
2016, Fig. 3



Betancourt 2009, Pl. 20B

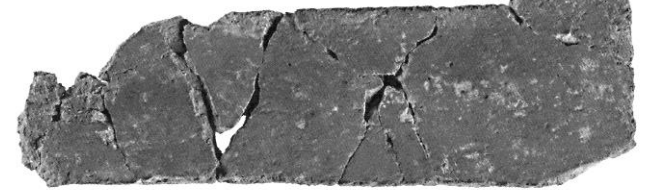
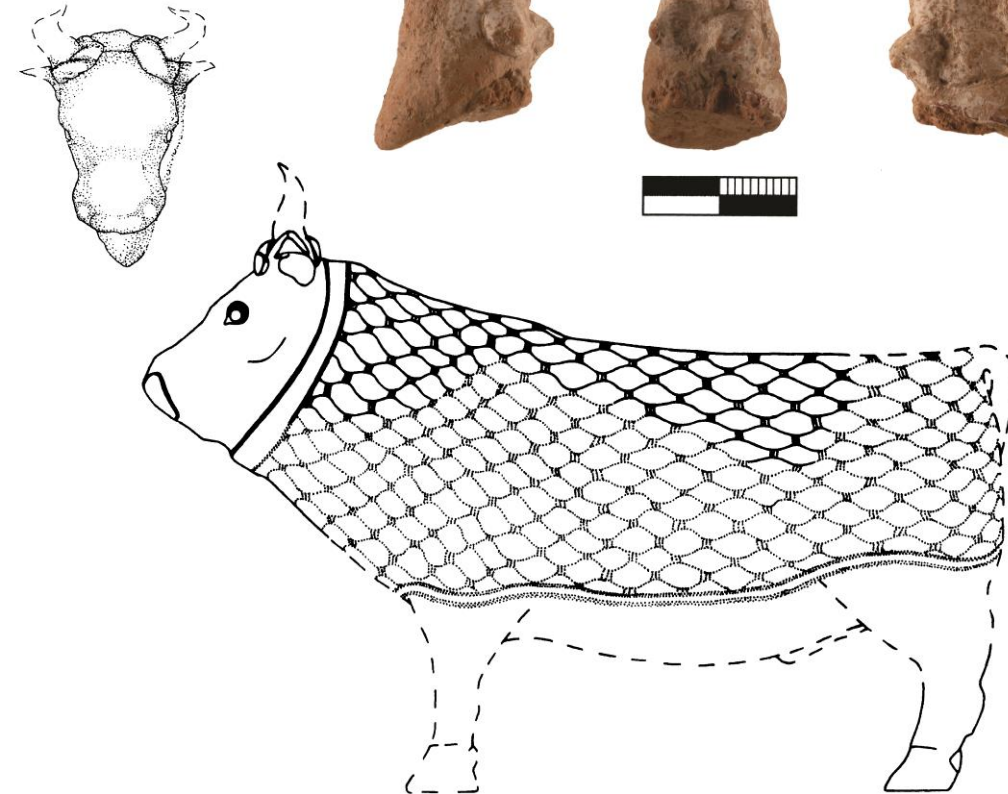

Plate 20B. Plaster strip H, upper side.



Betancourt 2009, Fig. 14



Betancourt 2009, Pl. 16

AF 305



House of the Rhyta, ground floor finds

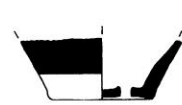

AF 286



AF 287



AF 288

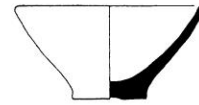

AF 289

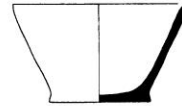

AF 290



AF 291

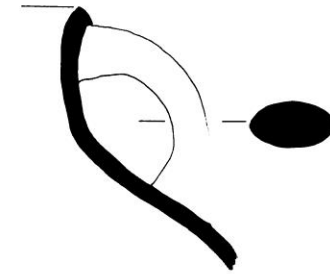

AF 292

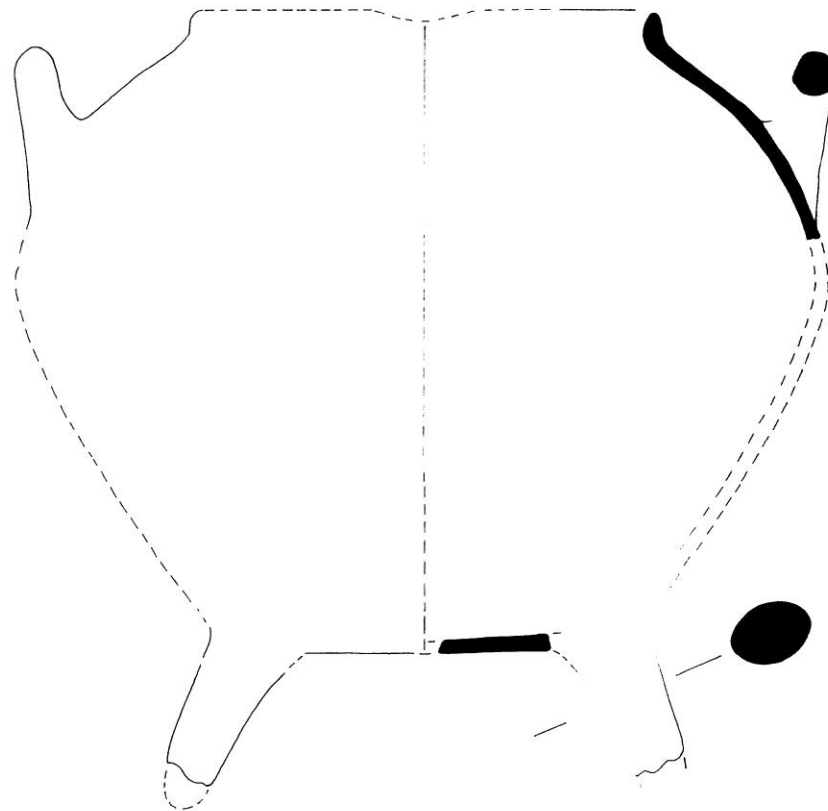

AF 293

3D state model of the House of the Rhyta, Pseira



3D reconstruction of the House of the Rhyta, Pseira

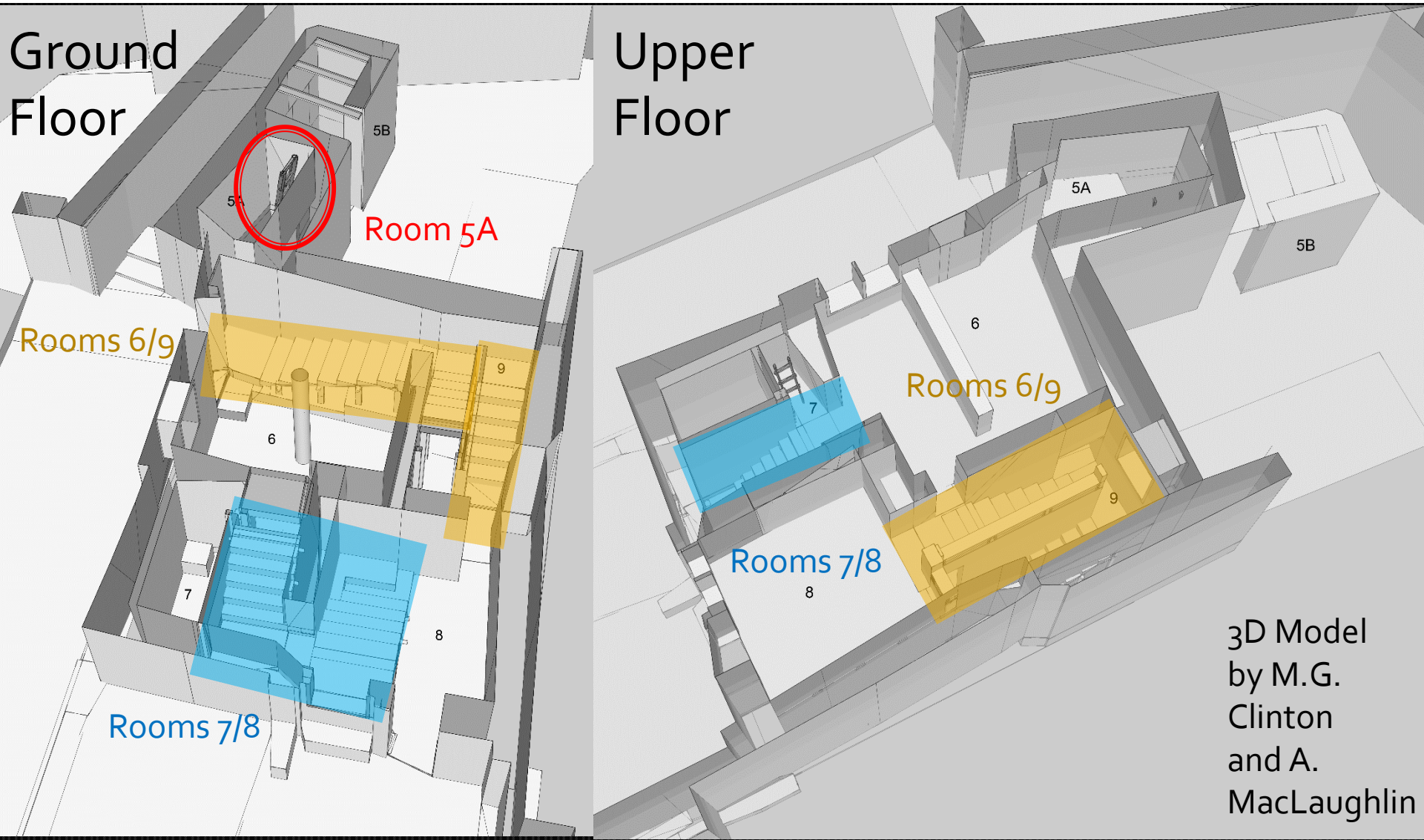

3D reconstruction

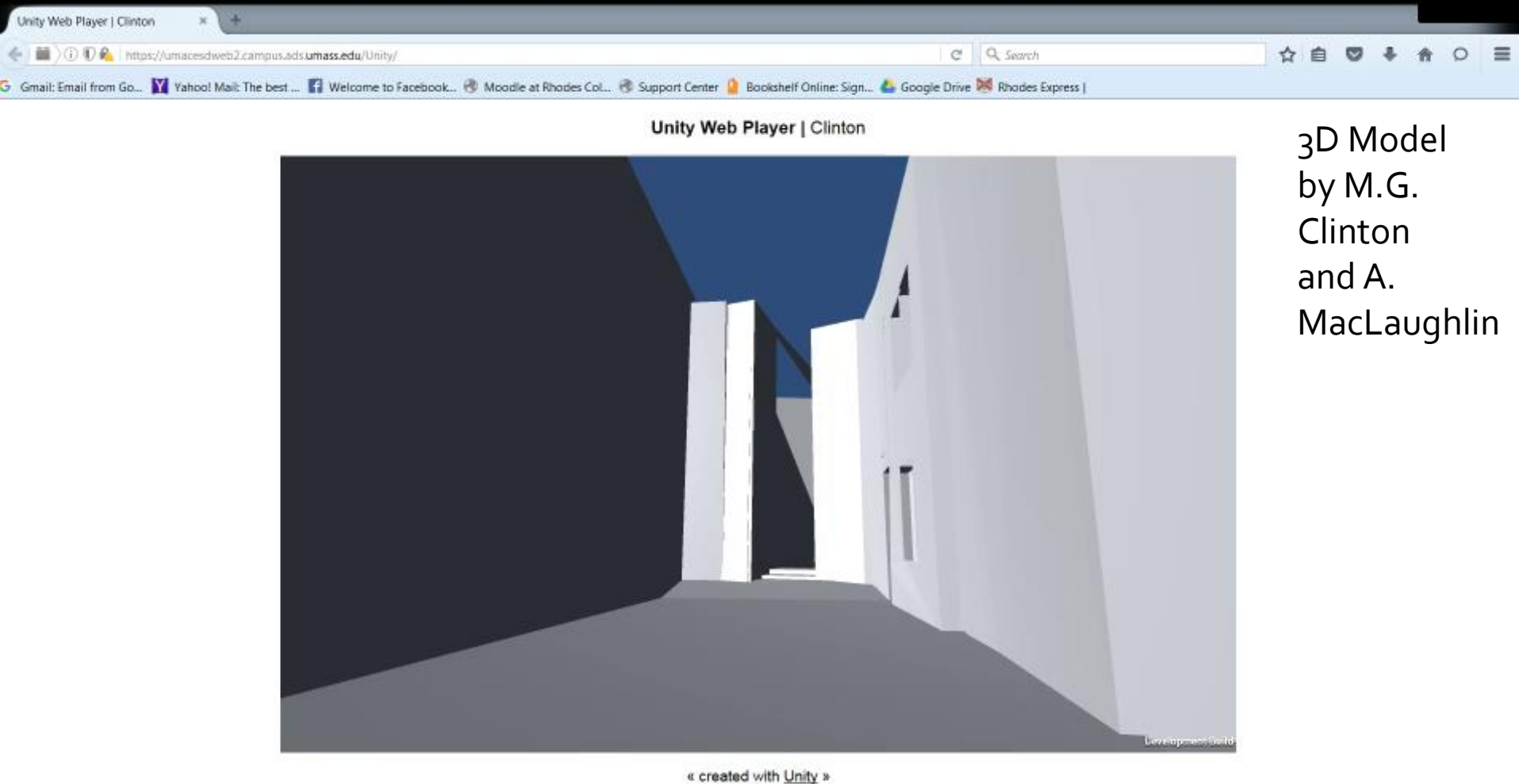

3D Model
by M.G.
Clinton
and A.
MacLaughlin

Access and circulation in the House of the Rhyta

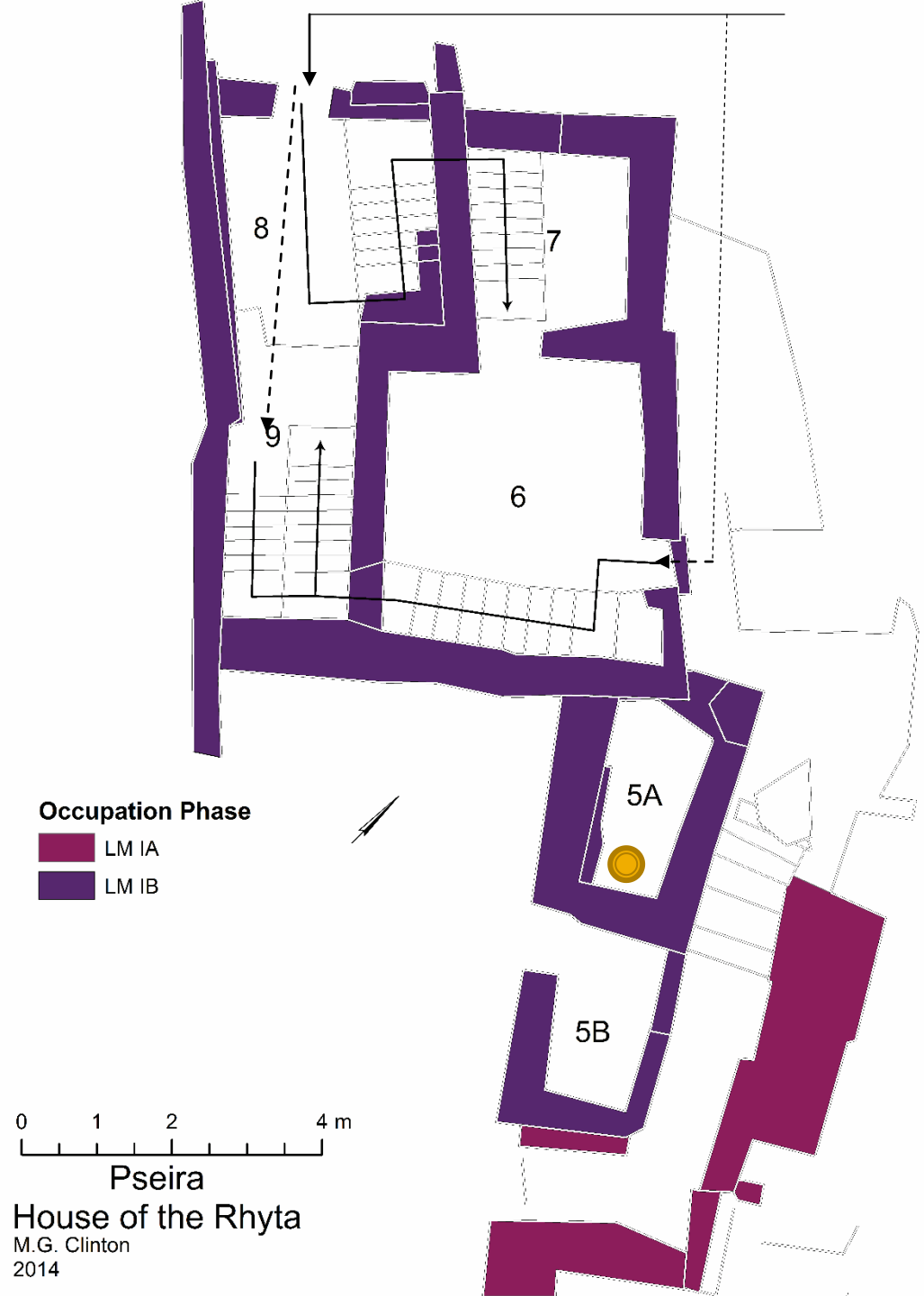

After Clinton 2016, Fig. 4

Palace of Knossos

Photo by Ryan P.



Roman house model

Model by Ray 2002



Bedroom

MODEL OF A ROMAN HOUSE

03/15/2013

Bronze key for chest or closet
Roman Imperial period
On loan from the Department of Classics,
University of Michigan, 1980. 1/18

Bronze door knocker or lifter ring
Roman Imperial period
If this piece was used as a lifting
ring, it may have been on a chest.
19.100.101

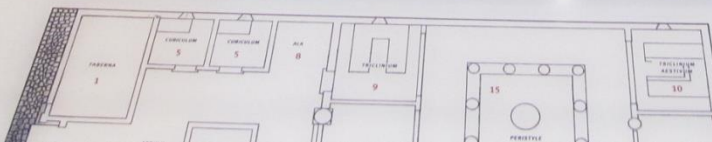

- 1 The house has two tablinae or shops at the front. One is leased to a food vendor and the other to a wine merchant. The rooms above are also leased, perhaps to the shop proprietors.
- 2 The fauces is the main passageway into the house.
- 3 The atrium is a courtyard open to the front.

- 4 The triclinia, or dining rooms, are characterized by a U-shaped arrangement of dining couches, each with places for three reclining diners. One is near the tablinum, two are at the back of the house and are used seasonally. The one facing the open peristyle courtyard (12) is the summer triclinium.
- 5 The alae are short hallways.
- 6-11 The triclinia, or dining rooms, are characterized by a U-shaped arrangement of dining couches, each with places for three reclining diners. One is near the tablinum, two are at the back of the house and are used seasonally. The one facing the open peristyle courtyard (12) is the summer triclinium.

Types of Privacy



Inhabitant / Visitor

Inhabitant / Inhabitant

Gamma Analysis: Chalinomouri

	Phase 1	Phase 2
Value of Integration	1.570	1.178
Mean Depth	2.333	2
Number of Cells	6	6

Phase 1

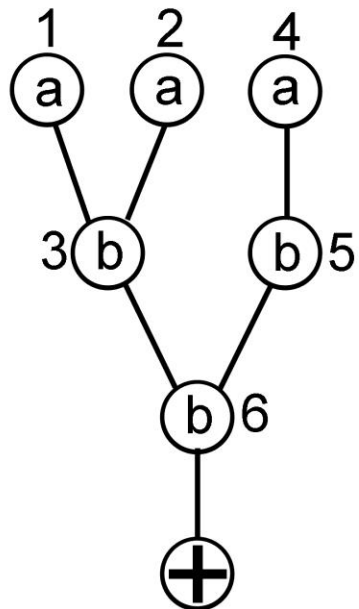

Phase 2

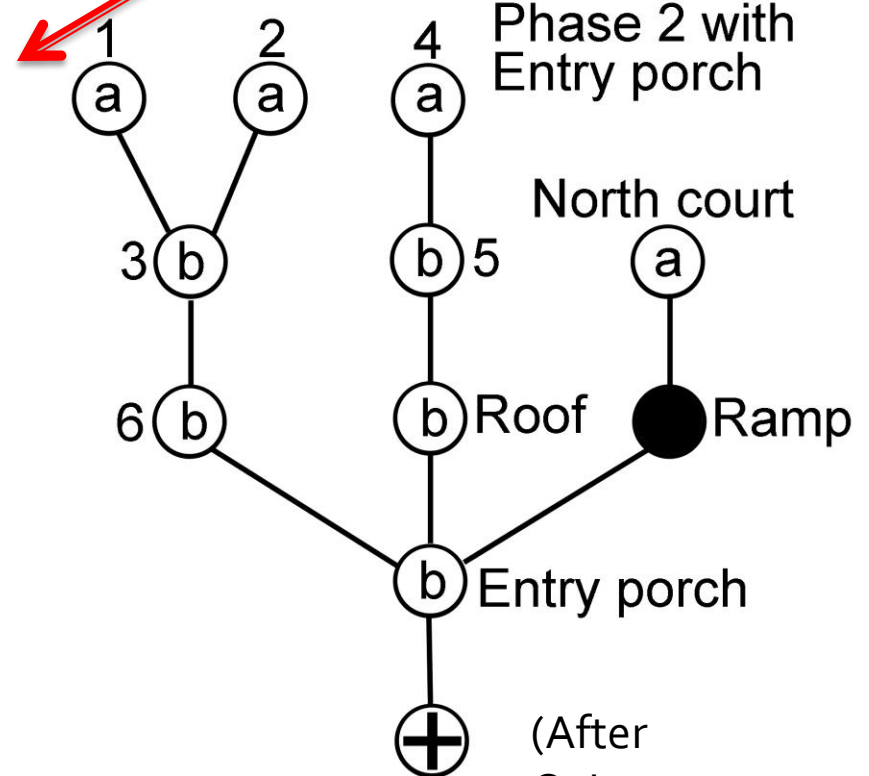
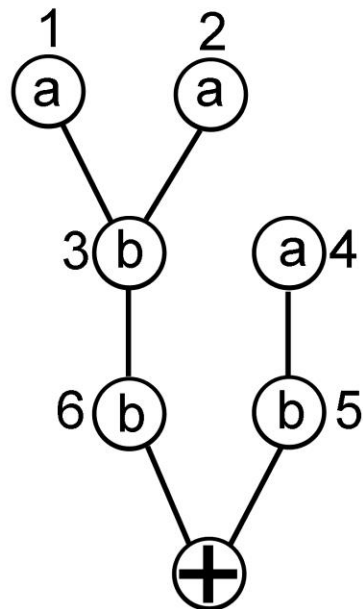

(After
Q. Letesson 2009)

Wallace-Hadrill

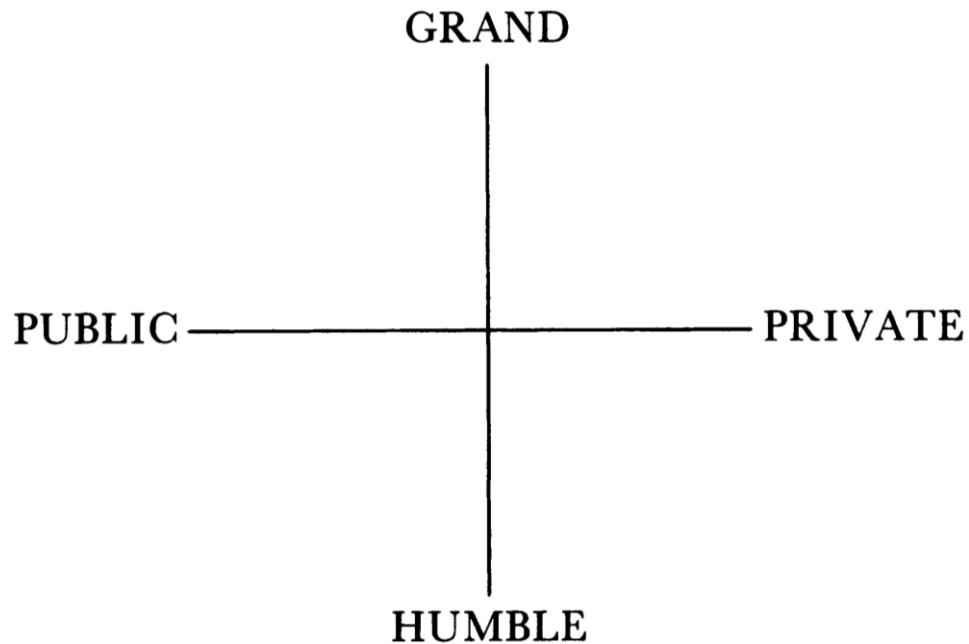

Wallace-Hadrill
1988, p. 55

Wallace-Hadrill 1998, Fig. 12
Pompeii, Casa degli Amanti, plan (after Elia).
Service areas shaded (2-3, 14-19). Note that
floor patterns distinguish the reception areas

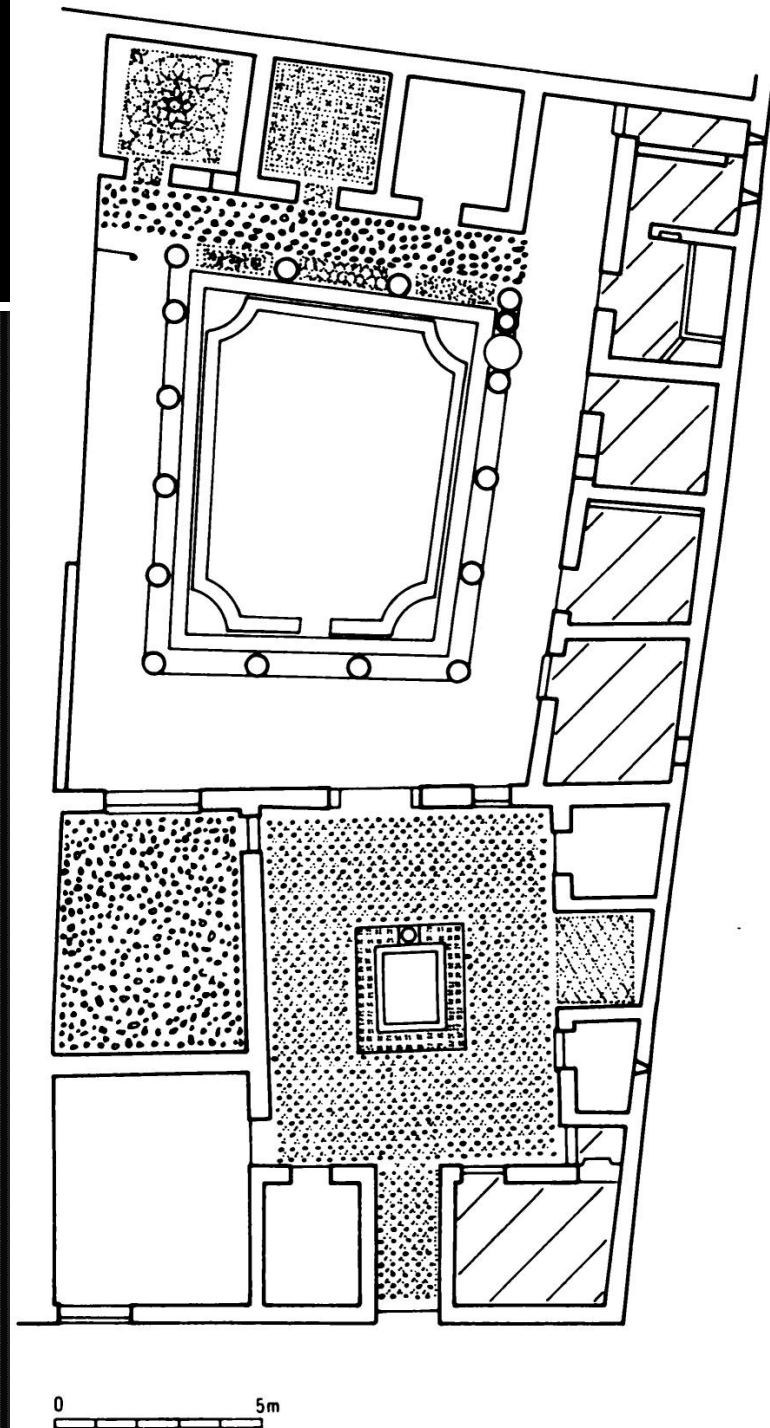

Relative Privacy

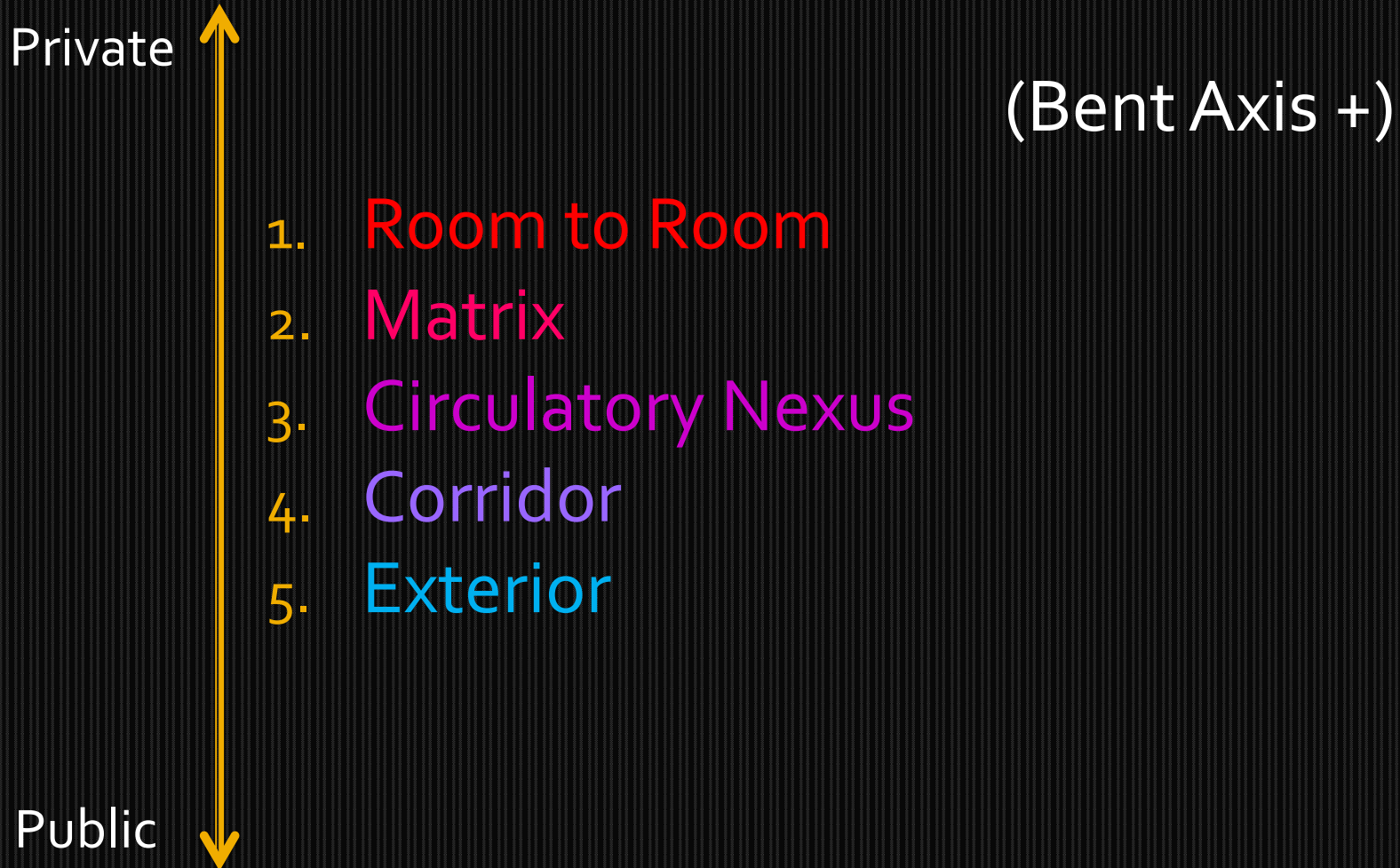

Matrix

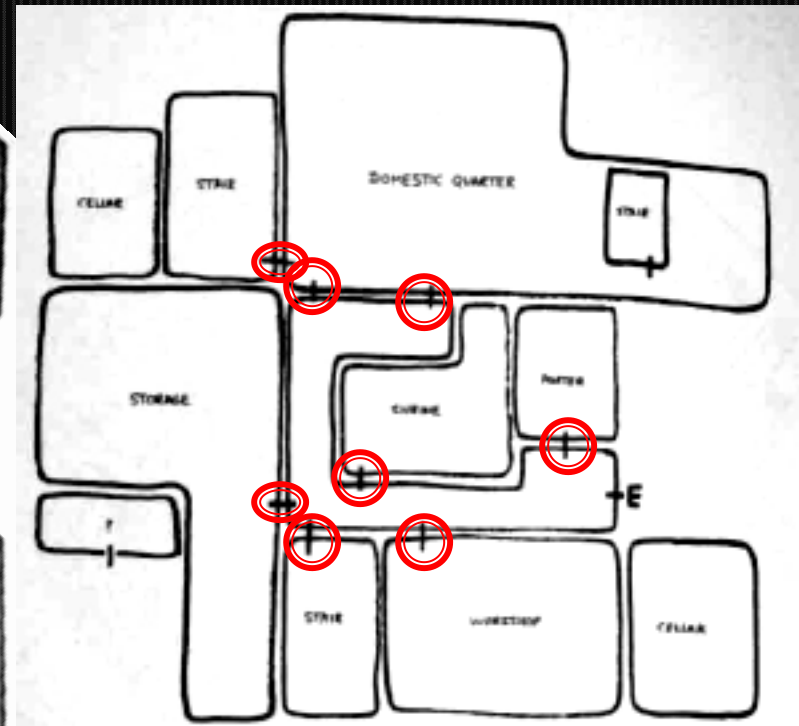
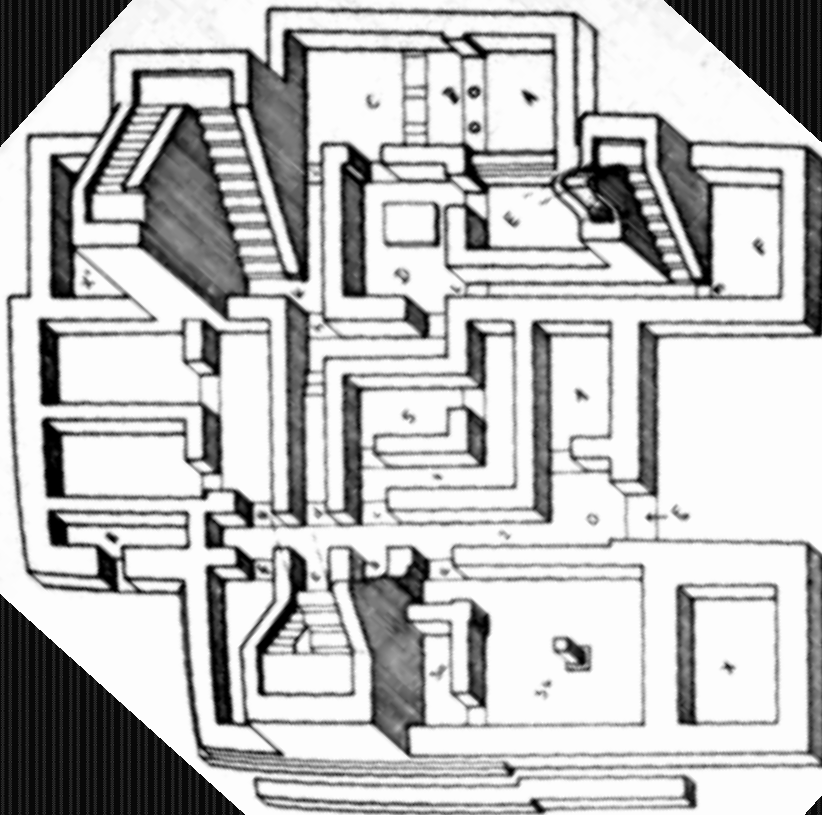

Matrix Organization in Tylissos C
(After Preziosi 1983)

Room to Room

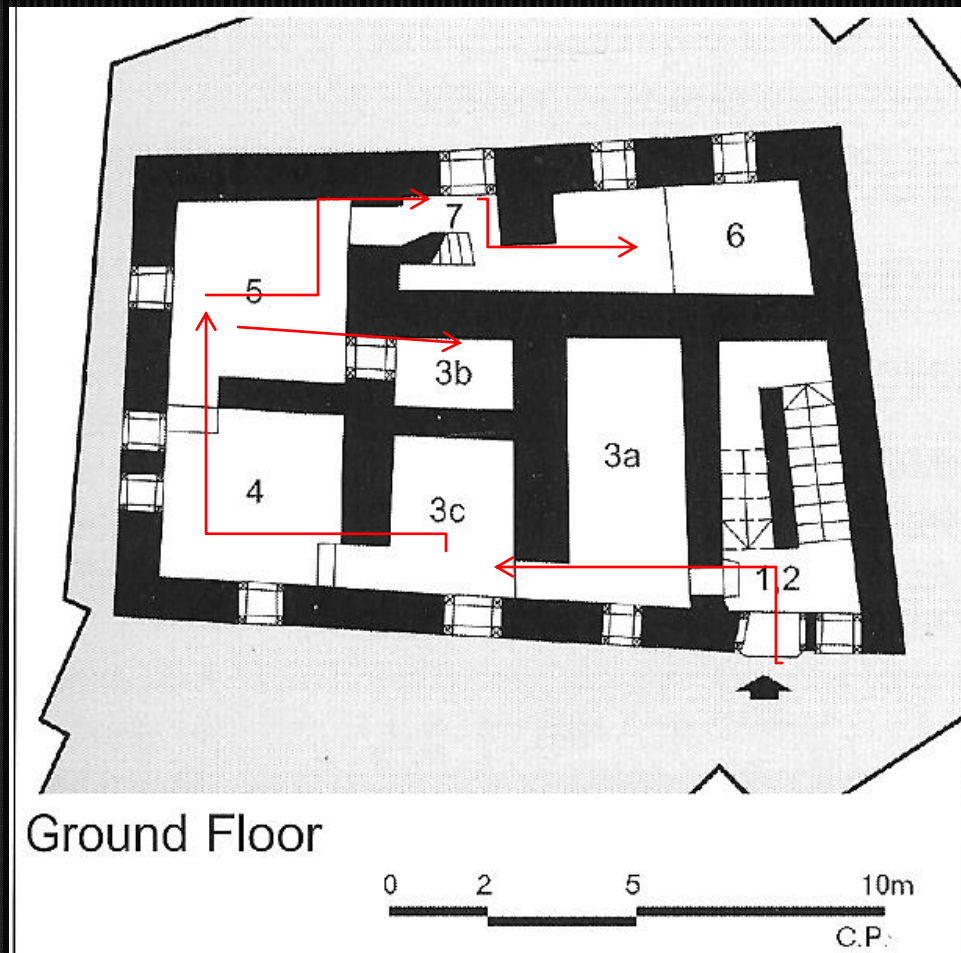

Room to Room Circulation in the West House, Akrotiri
(After Palyvou 2005)

Bent Axis

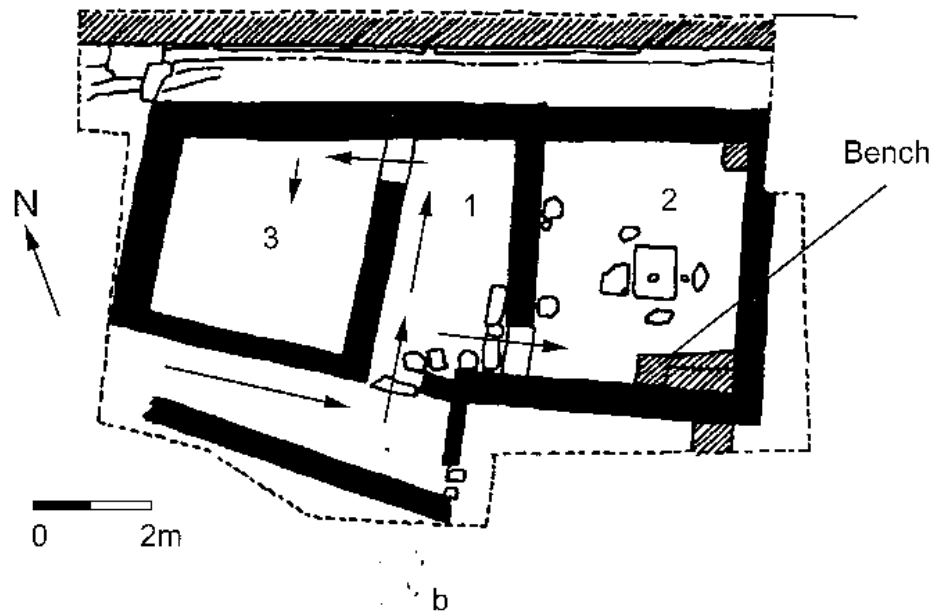
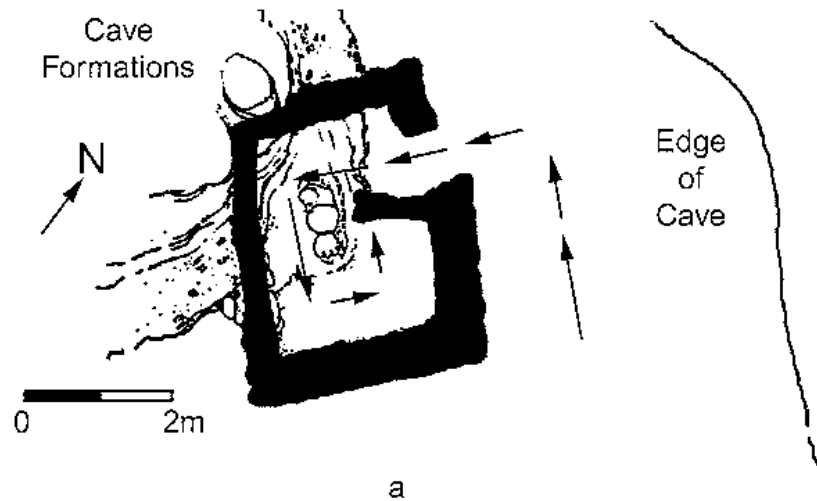

Bent Axis at Amnisos &
MM II Shrine at Malia
(Betancourt 2007)

Exterior

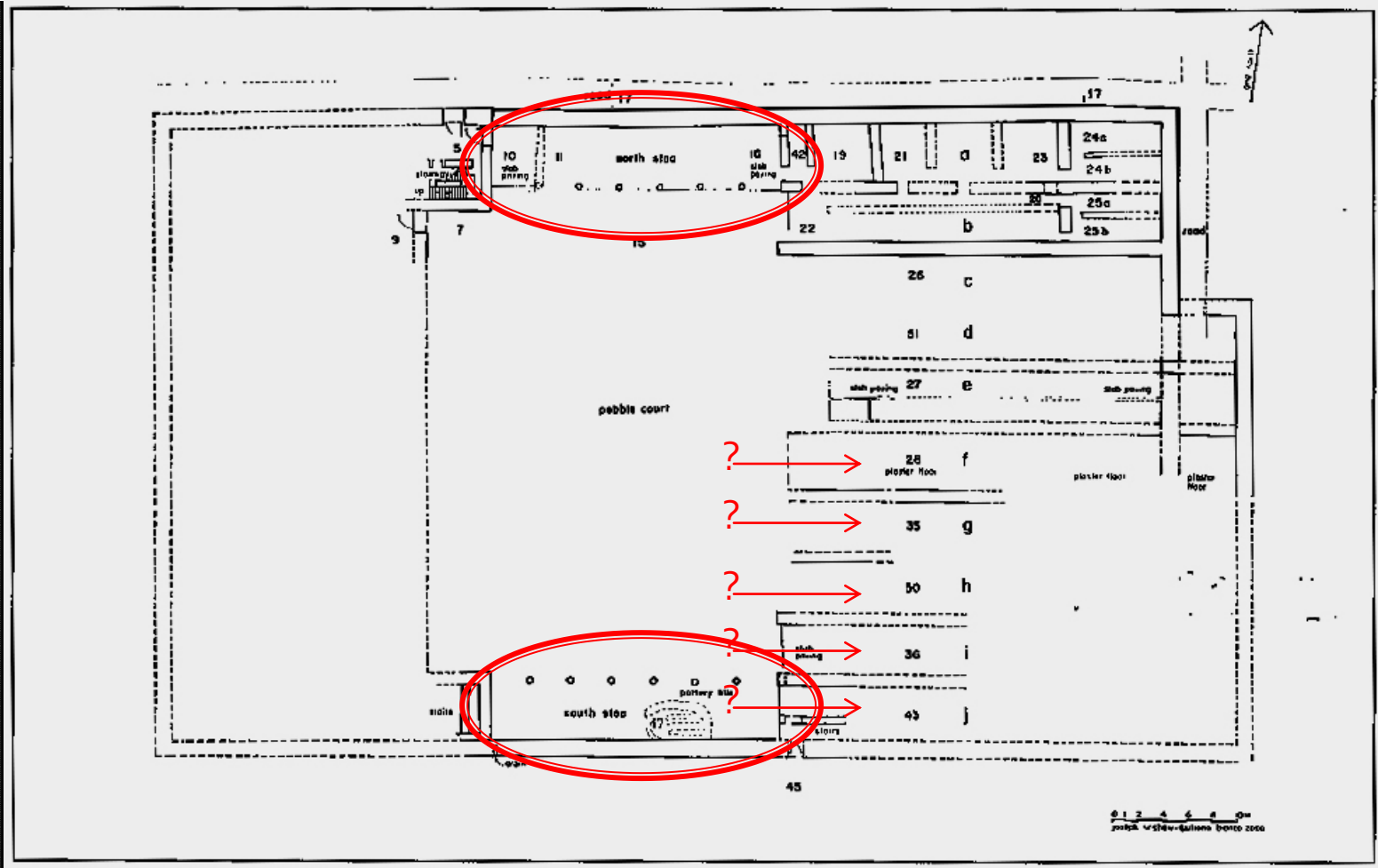

Exterior Circulation in Kommos Building T (Shaw 2006)

Access and circulation in the House of the Rhyta, Pseira

(Bent Axis +)★

1. Room to Room★
2. Matrix★
3. Circulatory Nexus
4. Corridor
5. Exterior★

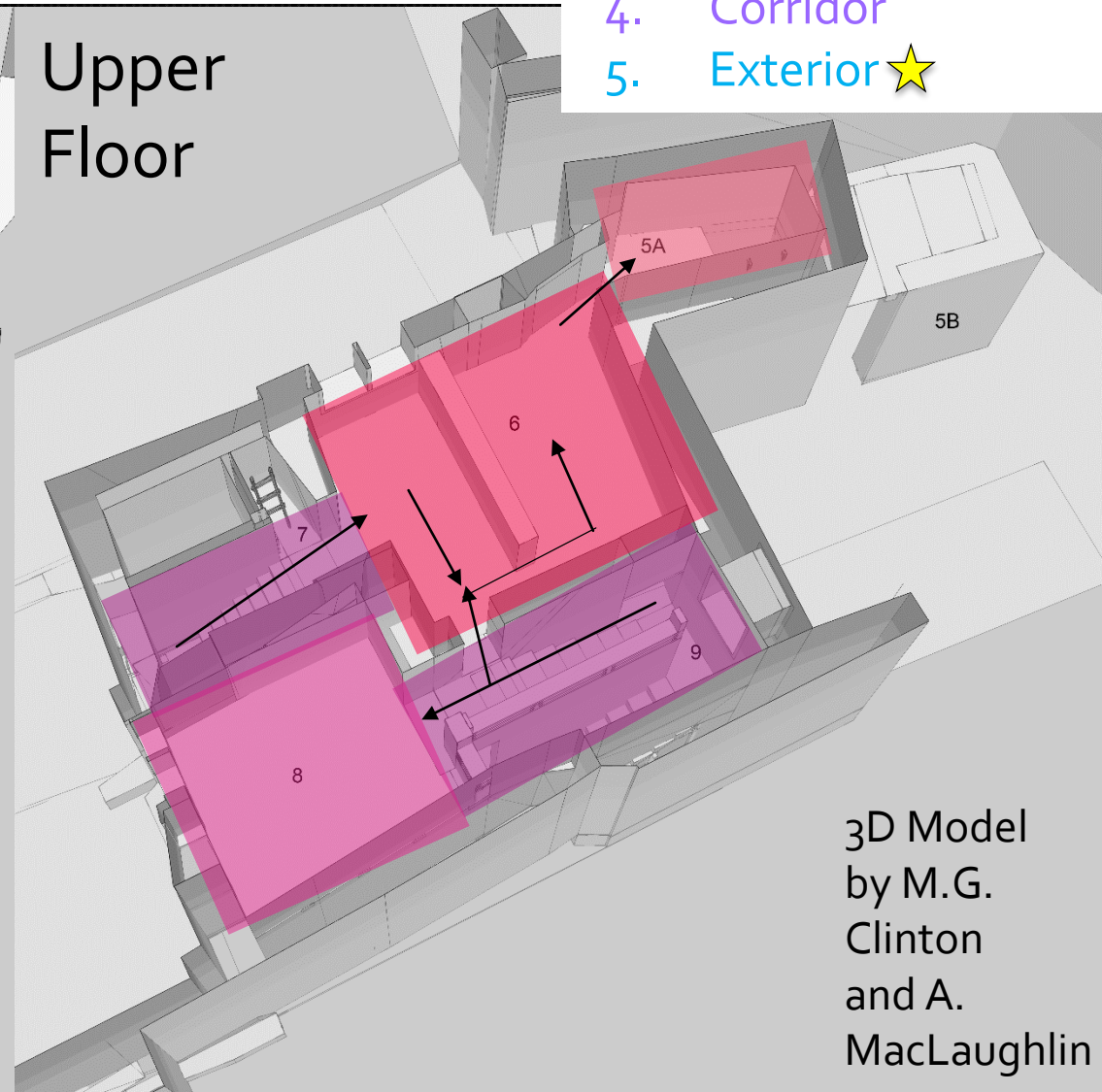
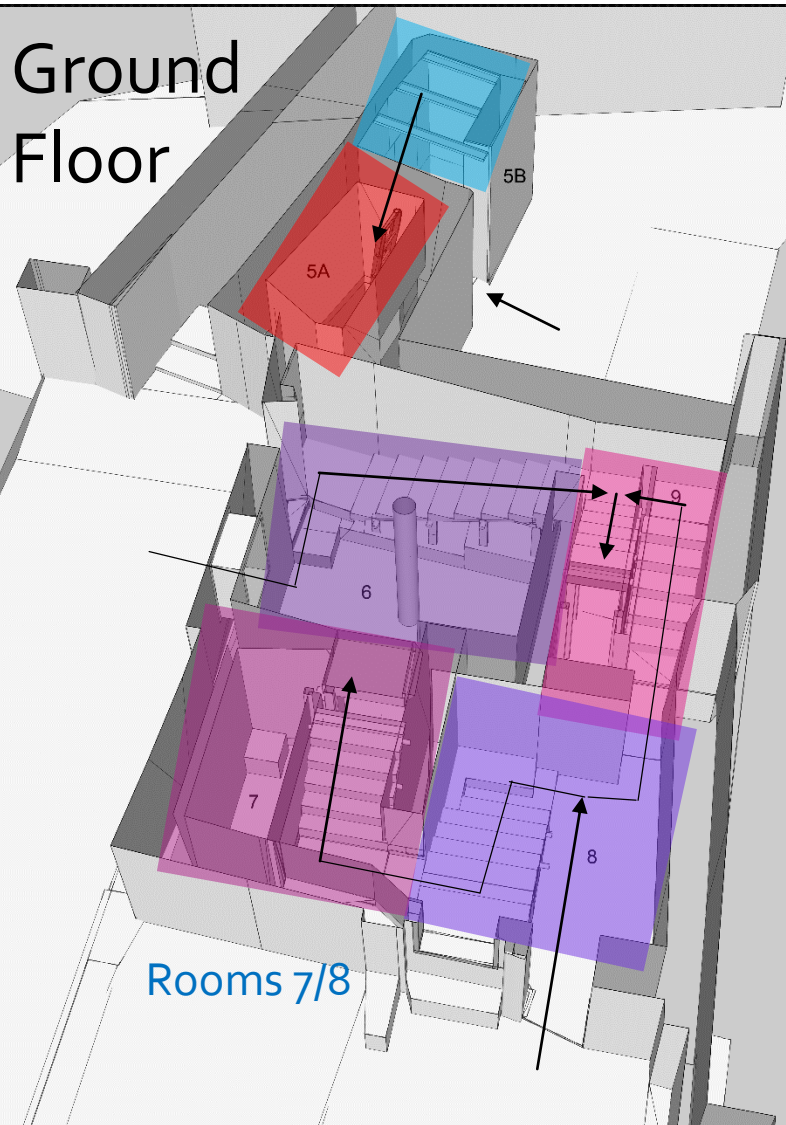

3D Model
by M.G.
Clinton
and A.
MacLaughlin

Wallace-Hadrill

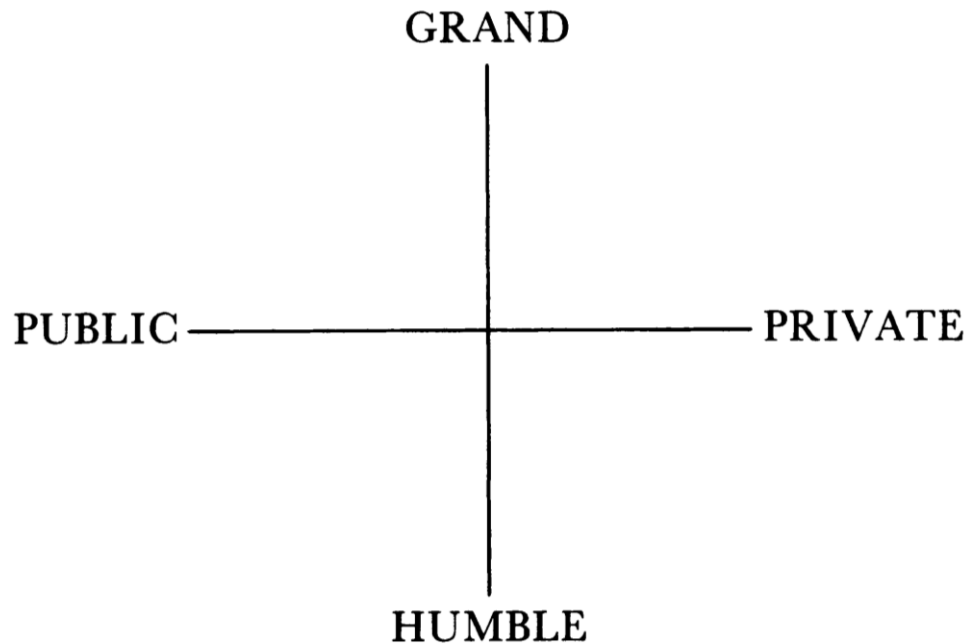

Wallace-Hadrill
1988, p. 55

Wallace-Hadrill 1998, Fig. 12
Pompeii, Casa degli Amanti, plan (after Elia).
Service areas shaded (2-3, 14-19). Note that
floor patterns distinguish the reception areas

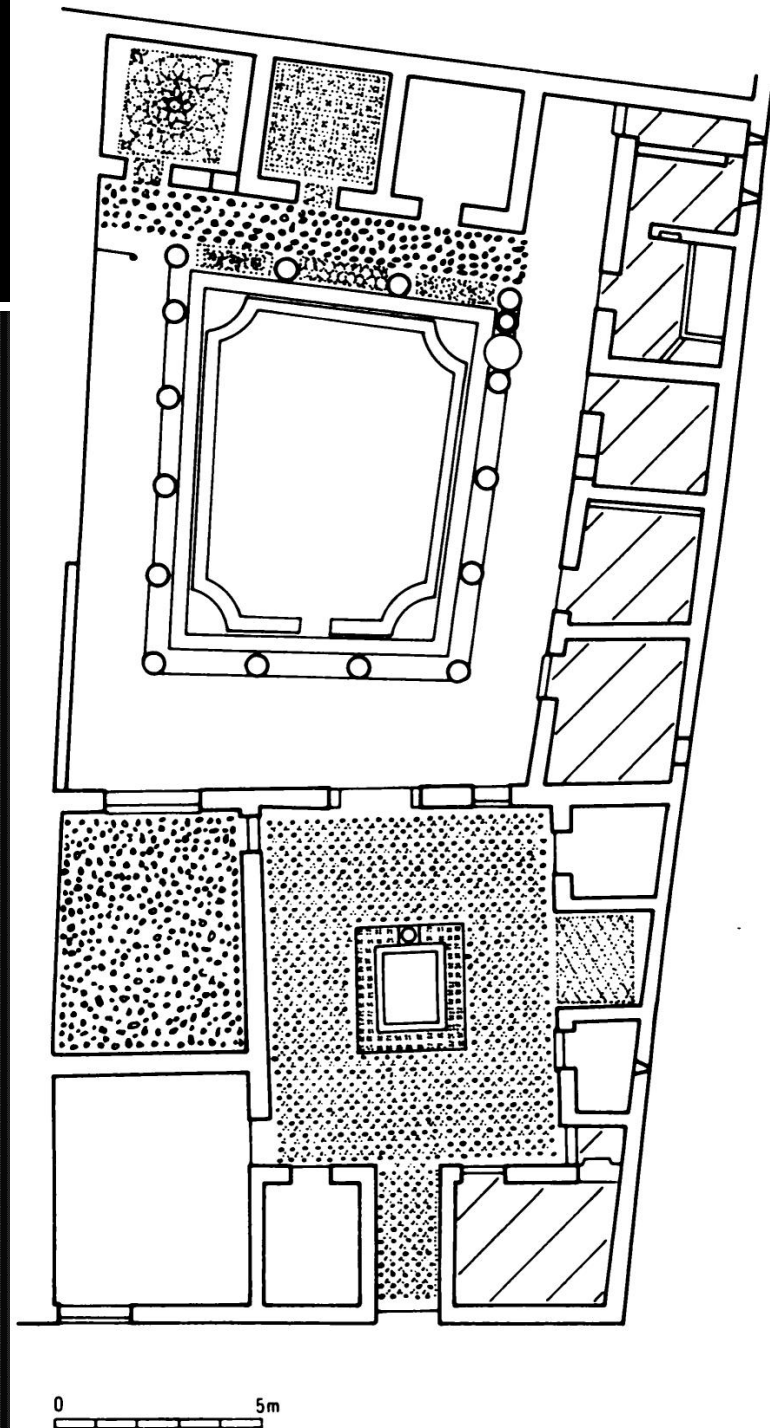

L-shaped bench outside Room 8



Clinton 2016, Fig. 5

Access and circulation in the House of the Rhyta

(Bent Axis +)★

1. Room to Room★
2. Matrix★
3. Circulatory Nexus
4. Corridor
5. Exterior★



Entrance to Room 8

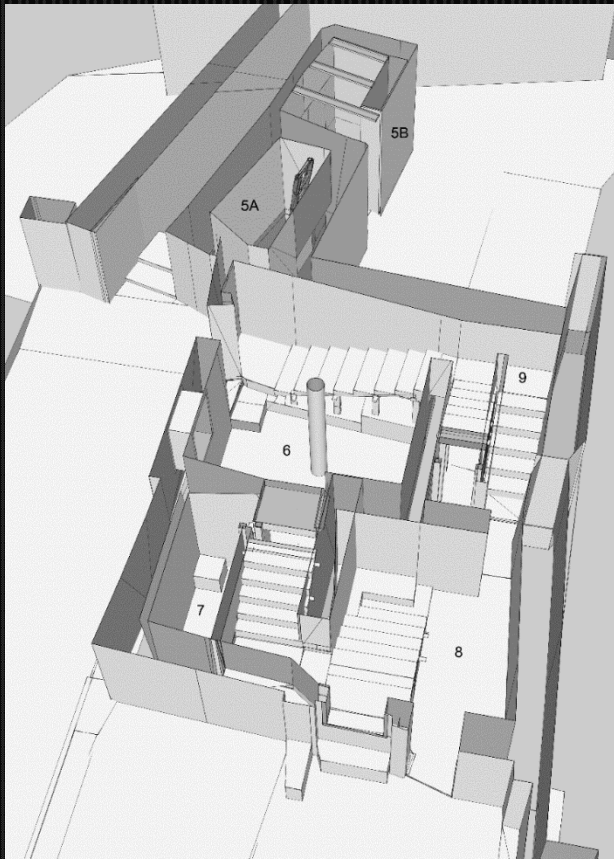

3D Model
by M.G. Clinton
and A. MacLaughlin



3D Model
by M.G. Clinton, D. Floyd,
and B. Wang

Position tracker

LRC Report

University of Massachusetts Am... (US) | https://umacesdweb2.campus.ads.umass.edu/PosTrack/report/show/2

Gmail: Email from Go... | Yahoo! Mail: The best ... | Welcome to Facebook... | Moodle at Rhodes Col... | Support Center | Bookshelf Online: Sign... | Google Drive | Rhodes Express |

Report List

All Room Transition Data

session_id	date_created	room	transition
1	2016-05-25 10:36:38.5700000	8	entered
1	2016-05-25 10:36:42.6570000	8	left
1	2016-05-25 10:36:42.7500000	9	entered
2	2016-05-25 10:38:39.9370000	8	entered
3	2016-05-30 21:48:25.4270000	8	entered
3	2016-05-30 21:48:30.2170000	8	left
3	2016-05-30 21:48:32.1500000	8	entered
3	2016-05-30 21:48:53.3500000	8	left
3	2016-05-30 21:48:53.6000000	9	entered
3	2016-05-30 21:48:54.0530000	9	left
3	2016-05-30 21:48:58.2630000	9	entered

EN 8:22 PM 6/20/2016

Detailed position tracker

LRC Report

University of Massachusetts Am... (US) | https://umacesdweb2.campus.ads.umass.edu/PosTrack/report/show/1

Search

Gmail: Email from Go... | Yahoo! Mail: The best ... | Welcome to Facebook... | Moodle at Rhodes Col... | Support Center | Bookshelf Online: Sign... | Google Drive | Rhodes Express |

Report List

All Position Data

session_id	date_created	x	y	z
1	2016-05-25 10:36:25.4970000	13	4	-23
1	2016-05-25 10:36:30.2700000	13	4	-24
1	2016-05-25 10:36:30.5670000	13	4	-25
1	2016-05-25 10:36:30.8800000	13	4	-26
1	2016-05-25 10:36:31.1600000	13	4	-27
1	2016-05-25 10:36:31.4730000	14	4	-28
1	2016-05-25 10:36:33.1870000	13	4	-29
1	2016-05-25 10:36:33.4870000	12	4	-29
1	2016-05-25 10:36:33.7800000	10	4	-29
1	2016-05-25 10:36:34.0930000	9	4	-29
1	2016-05-25 10:36:34.9200000	10	4	-29

EN

8:23 PM 6/20/2016

Thank you



Philip P. Betancourt
Temple University
Art & Art History



Darren Floyd
Rhodes College
Art & Art History



Rhodes College Students:
Kayce Boehm '19, Katie Clark '20, Ansel
MacLaughlin '16, Baobao Wang '18



NATIONAL
ENDOWMENT
FOR THE
HUMANITIES



Penn
UNIVERSITY of PENNSYLVANIA



Rhodes College
—1818—

The Institute for
Aegean Prehistory



THE AMERICAN SCHOOL
OF CLASSICAL STUDIES AT ATHENS